

RHIMCO

INDUSTRIES, INC.

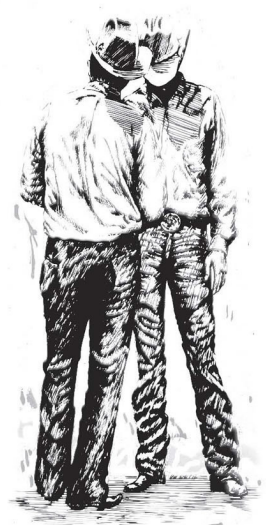

MEDIUM DUTY CIRCULAR CONNECTORS



MTMS SERIES

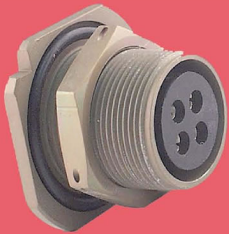

MTBFR SERIES



MTPC SERIES

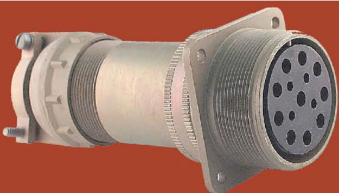

MTMOD SERIES



MTMC SERIES

TABLE OF CONTENTS

General Description / Ordering Information

MTMS A Series Plugs / Receptacles

MTMS C Series Plugs / Receptacles
(See NOTES on MTMSA Cover sheet)

MTMS E Series Plugs / Receptacles

MTMS F Series Plugs / Receptacles

MTMS R Series Plugs / Receptacles

5015 Modified Connectors
MTMSM / MTMSML

MTMOD

MTTBF

MOD Accessories

MTPC Series Connectors

MTMC Miniature Connectors

MTK Standard Connectors

Contact Information

Insert Information

MTVSC Stage Lighting System

MTCC91755 Cam-Coupling Series Plugs / Receptacles

MT11751-1 Battery Plug

MTPC Type Insert Arrangements

Standard Accessories

Other series connectors available thru Rhimco



CONTACT RHIMCO FOR ANY OTHER STYLES OR CONFIGURATIONS YOU
MAY BE LOOKING FOR. NO MATTER IF YOU NEED ONE PIECE OR 1000,
RHIMCO ENGINEERING WILL WORK WITH YOU TO COME UP WITH A
SATISFACTORY PART FOR ANY SITUATION.

OTHER RHIMCO CONNECTORS

MTQWL



The Rhimco MTQWL series connector complies with the heavy duty and strict environment requirements of Missile launching equipment, aircraft ground support equipment. In non military applications this rugged series of connectors is found in mining, oil field, heavy construction.

The accessory thread on MTQWL connectors are left handed.

MTWLD



The Rhimco MTWLD series connector meets or exceeds all test requirements defined in Mil-C-22992 and Mil-C-85049.

MTWLD adapters are also available in:

- * Various materials including Stainless Steel, Nickel / Copper, ect. (consult factory)
 - * EMI protection available
 - * Fuel resistant rubber
-

MTMB(B)



The Rhimco MTMS(B) series connectors are designed around Mil-C-5015 basic insert layout/positions and polarization. They differ mainly in that they employ a positive locking quick bayonet disconnect coupling system

MTPT



The MTPT miniature connectors are available in five different service classes.

- A - General Duty
 - E - Environment resisting
 - P - Potting Boot
 - W - Cable moistureproof.
 - WF- Cable moistureproof with strain relief.
-

This information is intended to illustrate and briefly describe a few series in Rhimco's connector product line. All connectors are designed and produced in accordance with the highest engineering, manufacturing, and quality requirements, and are backed by the reputation and expertise of Rhimco Industries, Incorporated. Each is available in a variety of configurations.

Detailed information concerning any connector is available upon request through our sales department. To obtain a sales drawing, or for further information regarding electrical connectors, contact Rhimco Industries, Inc.

This Page Intentionally left blank

GENERAL DESCRIPTION

MT5015 connectors with threaded coupling, conform to requirements of MIL-C-5015.

The class designations and general descriptions are as follows:

Class

- "A" Intended for general utility usage to provide convenient means of connecting and disconnecting electrical circuits in aircraft, vehicles, buildings, etc.
- "C" Intended for use on pressurized bulkheads or pressure barriers. Air leakage is limited to 1 cubic inch per hour at 30 lbs per square inch. See NOTES on on MTMSA Cover sheet.
- "E" Environmental resisting where the connector is subject to rapid changes in temperature or heavy condensation and / or vibration.
- "F" Environmental resisting provided with grommet seal and cable clamp. Contacts and inserts are bonded into shell creating a moisture seal in the mated condition.
- "R" A lightweight compact version of the Environmental MTMSF connectors without a cable clamp.

HOW TO ORDER

RHIMCO'S EXAMPLE PART NUMBER

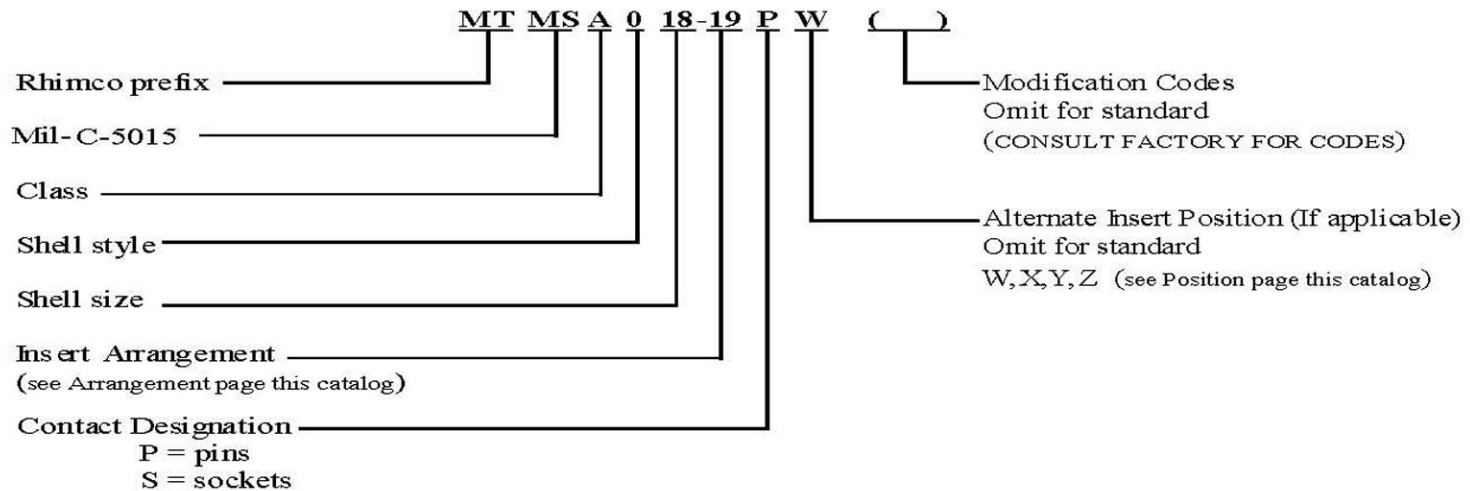

SHELL STYLE

- 0 - Wall Mounting Receptacle
- 1 - Cable Connecting Receptacle
- 2 - Box Mounting Receptacle

- 6 - Straight Plug
- 7 - Quick Disconnect Plug
- 8 - 90 Degree Plug

COMMON MODIFICATION CODES

- 124 - Silver Plated Crimp Contacts
- 687 - Nickel Plated Shell Parts

MTMS-A CONNECTORS

The MTMSA series connectors are designed for the general utility usage in aircraft, vehicle and in buildings.

Shell components;

Fabricated from high grade aluminum alloys and cadmium plated per QQ-P-416 with olive drab chromate after treatment.

Contacts;

Are SILVER plated solder type, with closed entry design in size 16 socket contact.

Inserts;

Are per MIL-R-3065 for maximum vibration and moisture resistance.

NOTE, MTMSC series have the same design and dimension as the MTMSA series connectors.



ACCESSORIES

MS90563
CLASS L



MS90564
CLASS L



Mil-C-22992
MS18062



MS17349



MS17350



M85049/59
MS90568



MS3181
(M83723/44)



Mil-C-26482
MS3180
(M83723/46)



MS3115



Mil-C-81703

MS3135



MS3183



Mil-C-28840
M28840/7



Mil-C-28518

MS24700

MS24695



MS3105



Mil-C-5015

MS25043



MS25042



MIL-C-38999

M38999/10

M38999/22



Mil-C-38999

M38999/32

M38999/33



MS27510



MS27511



MS27501



MS27502



MS27351

MS27353

MS20048

MS20047

Mil-C-83723

M83723/61-1

M83723/61-2

M83723/59-2

M83723/60-2

M83723/59-1

M83723/60-1



MS27296

MS27297

MS27293

MS27294

MS27292

MS27295

MT11751-1 BATTERY PLUG

MT11751-1 Battery plug connectors make removal and installation of storage batteries, starting motors, and any portable or stationary power source fast and easy. This allowing batteries to be recharged and placed back in to service quick. The MT11751-1 Battery plug is also used to connect auxiliary power equipment to electrical systems.

The MT11751-1 Battery plug may be used on batteries conforming to MIL-B-6146.

Covers are made of molded phenolic

The handle is made of aluminum

The socket contacts accept size 2/0 wires and are rated at 600 AMPS, Based on a maximum of 2 hours service or before a temperature of 120 degrees.

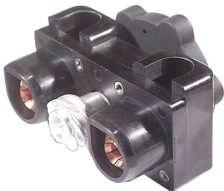



MTMSA 0 WALL MOUNTING RECEPTACLE

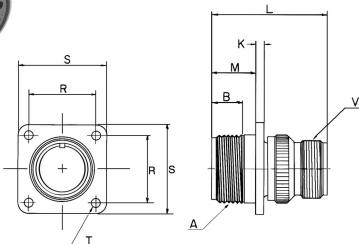

Shell Size	A Thread Class 2A	B Min Full Thd	K Max Min	L Max	M +.031 -0.00	R +/- .005	S +/- .031	T +.010 -.005	V Thread Class 2A
8S	.5000-28UNEF	.391	.156	.062	1.469	.594	.875	.120	.5000-28UNEF
10S	.6250-24NEF				.562	.719	1.000		.6250-24NEF
10SL		1.531							
12S	.7500-20UNEF	.450			1.500	.812	1.094		.7500-20UNEF
14S	.8750-20UNEF	.625	1.875	.750					
14S	.8750-20UNEF	.450	1.500	.562	.906	1.188			
14		.625	1.875	.750					
16S	1.0000-20UNEF	.450	1.500	.562	.969	1.281		.8750-20UNEF	
16			1.875						
18	1.1250-18NEF	.203	.094	2.062	.750	1.062	1.375	.147	1.0000-20UNEF
20	1.2500-18NEF				1.156	1.500	1.1875-18NEF		
22	1.375-18NEF				1.250	1.625			
24	1.5000-18NEF				1.375	1.750			
28	1.7500-18NS	.625		2.250	.812	1.562	2.000	.173	1.4375-18NEF
32	2.0000-18NS				1.750	2.250			
36	2.2500-16UN				1.938	2.500			
40	2.5000-16UN				2.188	2.750			
44	2.7500-16UN	.359	.125	2.375	.875	2.375	3.000		2.5000-16UN
48	3.000-16UN					2.625	3.250		3.0000-16UN

RHIMCO'S EXAMPLE PART NUMBER

MTMSA 0 18-19 P W ()

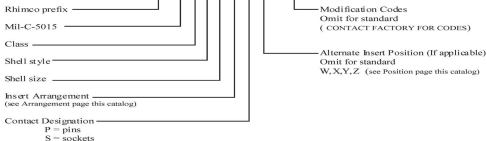

MTMSA 1 CABLE CONNECTING PLUG

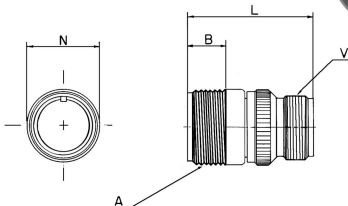

Shell Size	A Thread Class 2A	B Min Full Thd	L Max	N Max	V Thread Class 2A
8S	.5000-28UNEF	.391	1.469	.562	.5000-28UNEF
10S	.6250-24NEF		1.531	.640	
10SL	.6250-24NEF	.450	1.500	.760	.6250-24NEF
12S	.7500-20UNEF		1.875		
12	.7500-20UNEF	.625	1.500	.875	.7500-20UNEF
14S	.8750-20UNEF		1.875		
14	.8750-20UNEF	.450	1.500	1.031	.8750-20UNEF
16S	1.0000-20UNEF		1.875		
16	1.0000-20UNEF	.625	2.062	1.150	1.0000-20UNEF
18	1.1250-18NEF		1.265	1.421	1.1875-18NEF
20	1.2500-18NEF	.625	2.250	1.562	1.4375-18NEF
22	1.3750-18NEF			1.781	
24	1.5000-18NEF	.625	2.375	2.250	2.0000-18NS
28	1.7500-18NS			2.500	2.2500-16UN
32	2.0000-18NS	.625	2.562	2.966	2.5000-16UN
36	2.2500-16UN			3.219	3.0000-16UN
40	2.5000-16UN	.625	2.562	2.966	2.5000-16UN
44	2.7500-16UN			3.219	3.0000-16UN
48	3.0000-16UN	.625	2.562	2.966	2.5000-16UN
				3.219	3.0000-16UN

RHIMCO'S EXAMPLE PART NUMBER

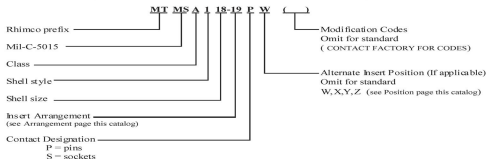

MTCC91755 CAM-COUPLING SERIES PLUGS & RECEPTACLE

This low resistance single conductor connector and receptacle allows quick connecting or disconnecting of equipment. They have become the industry standard for welding power supplies, distribution panels, stress relieving, and many other low voltage applications.

The double cam provides a positive, vibration proof connector.

All connectors with in a series have the same connection diameter. So Interconnectability is established.

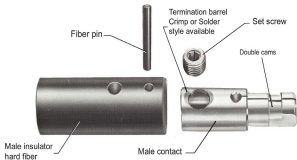

MTCC91755 SERIES Protective Caps

MTCC91755 SERIES Cable Connectors



RECEPTACLE

PLUG

MTCC91755 * ** *** ****

*	PLUG
CP	RECEPTACLE

**	CABLE SIZE
50	#8 - #2
60	#2 - 4/0
70	350 - 750MCM

A	SOLDER
B	CRIMP
C	SET SCREW

1	BLACK
2	RED



PLUG

RECEPTACLE

MTCC91755-3 * **

*	
P	PLUG
R	RECEPTACLE

**	SIZE
50	50
60	60
70	70

MTCC91552 SERIES THREADED STUD PANEL MOUNT



PLUG



RECEPTACLE

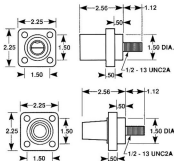

MTCC917552 * **

*	
P	PLUG
R	RECEPTACLE

**	
1	BLACK
2	RED
3	GREEN
4	WHITE
5	BLUE

MTVSC STAGE LIGHTING SYSTEM

Rhimco introduces the MTVSC threaded coupling multipin connector. The Rhimco MTVSC connector is a more rugged version of Veams[®] VSC and Socapex[®] "419" series connectors. The Rhimco MTVSC has a machined aluminum shell with a ribbed rubber coated coupling nut for added protection from being drop from high places and provides easy manual coupling and uncoupling. Both solder and crimp removable contacts are available. All of the MTVSC connector components are replaceable.



MTVSC032-19S -CG RECEPTACLE



MTVSC632-19P -WS RECEPTACLE



MTVSC632-19P -CG RECEPTACLE

Rhimco's MTVSC Connector provides a weather proof backshell and strain relief when assembled with the gland seal compression cable retention system or the wire grommet sealing system. These weather resisting systems, with the Black hard-anodized finish combined with the upgraded ruggedness and the modern appearance makes this the perfect connector for any lighting project.



MTMSA 2 BOX MOUNTING RECEPTACLE

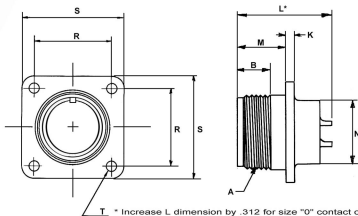

Shell Size	A Thread Class 2A	B Min Full Thd	K Max Min	*L Max	M +.031 -0.00	N +0.00 -0.20	R +.005	S +.031	T +.010 -0.005
8S	.5000-28UNEF	.391	.156	.062	1.191	.562	.532	.594	.875
10S	.6250-24NEF						.479	.719	1.000
10SL							.640		
12S	.7500-20UNEF	.450	.203	.094	1.750	.750	.604	.812	1.094
12		.625							
14S	.8750-20UNEF	.450							
14		.625							
16S	1.0000-20UNEF	.450							
16					1.191	.562	.864	.969	1.281
18	1.1250-18NEF	.625	.203	.094	1.750	.750	.988	1.062	1.375
20	1.2500-18NEF						1.135	1.156	1.500
22	1.3750-18NEF						1.260	1.250	1.625
24	1.5000-18NEF						1.385	1.375	1.750
28	1.7500-18NS						1.604	1.562	2.000
32	2.0000-18NS						1.854	1.750	2.250
36	2.2500-16UN						2.041	1.938	2.500
40	2.5000-16UN	2.291	2.188	2.750					
44	2.75000-16UN	.359	.125	2.188	.875	2.782	2.375	3.000	
48	3.0000-16UN					3.032	2.625	3.250	

RHIMCO'S EXAMPLE PART NUMBER

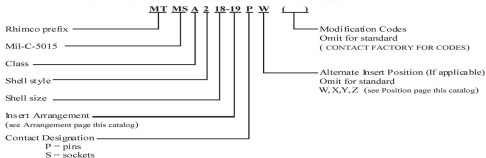

MTMSA 6 STRAIGHT PLUG

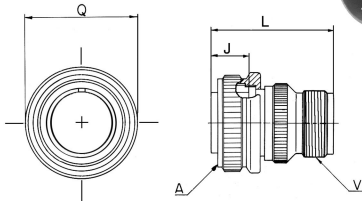

Shell Size	A Thread Class 2B	J +/--.005	L Max	Q Max	V Thread Class 2A	
8S	.5000-28UNEF	.531	1.425	.750	.5000-28UNEF	
10S	.6250-24NEF		1.503	.945	.6250-24NEF	
10SL						
12S	.7500-20UNEF	.719	1.878	.995	.7500-20UNEF	
12						
14S	.8750-20UNEF		.531	1.503	1.125	.7500-20UNEF
14			.719	1.878		
16S	1.0000-20UNEF		.531	1.503	1.250	.8750-20UNEF
16			1.878			
18	1.1250-18NEF		1.973	1.344	1.0000-20UNEF	
20	1.2500-18NEF		1.878	1.469	1.1875-18NEF	
22	1.3750-18NEF		1.973	1.594		
24	1.5000-18NEF		2.005	1.719	1.4375-18NEF	
28	1.75000-18NS		2.225	1.969		
32	2.0000-18NS		2.193	2.219		1.7500-18NS
36	2.2500-16UN		2.254	2.469	2.0000-18NS	
40	2.5000-16UN		2.223	2.719	2.2500-16UN	
44	2.7500-16UN		2.775	3.075	2.5000-16UN	
48	3.0000-16UN		3.000	3.375	3.0000-16UN	

RHIMCO'S EXAMPLE PART NUMBER

MT MS A 6 18-19 P W ()

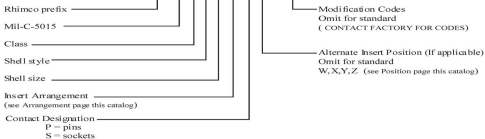

NOTES

This Page Intentionally left blank

NOTES

This Page Intentionally left blank



MTMSA 7 QUICK DISCONNECT PLUG

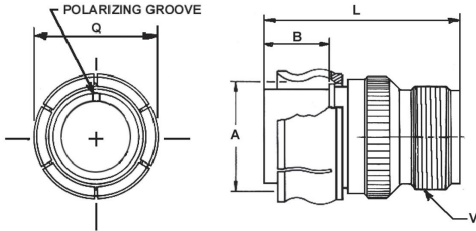

Shell Size	A Max Clamp size	B Engagement +/- .005	L Max	Q Max	V Thread Class 2A
8S	.500	.531	1.425	.720	.5000-28UNEF
10S	.625		1.503	.845	.6250-24NEF
10SL					
12S	.750	.719	1.878	1.000	.7500-20UNEF
12		.531	1.503		
14S	.875	.719	1.878	1.125	.8750-20UNEF
14		.531	1.503		
16S	1.000	.719	1.878	1.375	1.0000-20UNEF
16			1.973		
18	1.125	.719	1.879	1.625	1.1875-18 NEF
18			1.973		
20	1.250	.719	2.005	1.750	1.4375-18NEF
20			2.225		
22	1.375				
24	1.500				
28	1.750				

RHIMCO'S EXAMPLE PART NUMBER

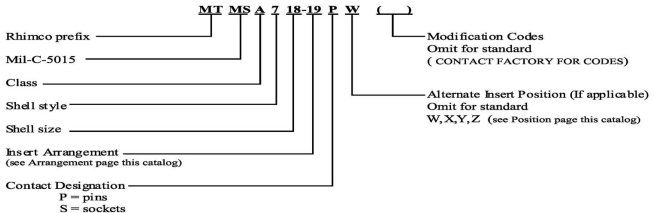

MTMSA 8 90-DEGREE PLUG

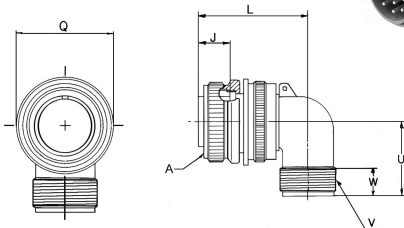

Shell Size	A Thread Class 2A	J +/- .005	L Max	Q Max	U	V Thread Class 2A	W Min
8S	.5000-28UNEF	.531	1.427	.750	.750	.5000-28UNEF	.375
10S	.6250-24NEF		1.458	.945			
10SL			1.482				
12S	.7500-20UNEF	.719	1.487	.995	.875	.6250-24NEF	
12			1.862				
14S	.8750-20UNEF	.531	1.651	1.125	1.000	.7500-20UNEF	
14		.719	1.926				
16S	1.0000-20UNEF	.531	1.677	1.250	1.062	.8750-20UNEF	
16			2.051				
18	1.1250-18NEF	.719	2.114	1.344	1.188	1.0000-20UNEF	
20	1.2500-18NEF			1.469	1.250	1.1875-18NEF	
22	1.3750-18NEF		2.364	1.594	1.312		
24	1.5000-18NEF			2.615	1.719	1.438	1.4375-18NEF
28	1.7500-18NEF				1.969	1.500	
32	2.0000-18NS			2.837	2.219	1.750	1.7500-18NS
36	2.2500-16UN			2.895	2.469	1.875	2.0000-18NS
40	2.5000-16UN			3.020	2.719	2.031	2.2500-16UN

RHIMCO'S EXAMPLE PART NUMBER

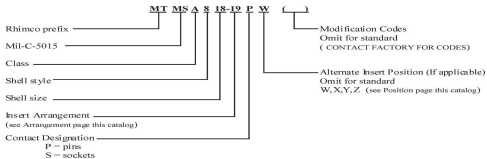

INSERT ARRANGEMENTS

Layouts

All views are looking into front of Pin Insert or rear of Socket Insert in normal position.

4
8
C
O
N
T
A
C
T
S

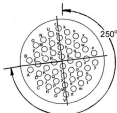
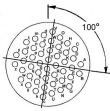

INSERT ARRANGEMENT:
NUMBER OF CONTACTS:
SIZE OF CONTACTS:

36-10
48
16

100° ROTATION OF 36-10

36-11
48
16

250° ROTATION OF 36-10

36-12
48
16

5
2
C
O
N
T
A
C
T
S



5
4
C
O
N
T
A
C
T
S



6
5
C
O
N
T
A
C
T
S

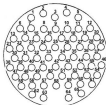

INSERT ARRANGEMENT:
NUMBER OF CONTACTS:
SIZE OF CONTACTS:

36-52
52
16

32-64
64
16

36A95
95
16

8
5
C
O
N
T
A
C
T
S

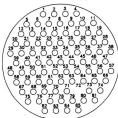
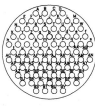

1
0
4
C
O
N
T
A
C
T
S

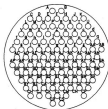

INSERT ARRANGEMENT:
NUMBER OF CONTACTS:
SIZE OF CONTACTS:

40-85
85
16

48-82
82
16

44-52
104
16

INSERT ARRANGEMENTS Layouts

All views are looking into front of Pin Insert or rear of Socket Insert in normal position.

3
1
C
O
N
T
A
C
T
S



36-9
31

1-4, 2-8, 14-12, 14-16

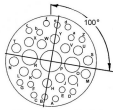

100° OF ROTATION OF 36-9

36-18
31

1-4, 2-8, 14-12, 14-16

3
4
C
O
N
T
A
C
T
S



36-20
34

2-8, 2-12, 30-16

INSERT ARRANGEMENT:
NUMBER OF CONTACTS:
SIZE OF CONTACTS:

INSERT ARRANGEMENT:
NUMBER OF CONTACTS:
SIZE OF CONTACTS:

INSERT ARRANGEMENT:
NUMBER OF CONTACTS:
SIZE OF CONTACTS:

4
4
C
O
N
T
A
C
T
S



32-59
44
2-8, 42-16

4
6
C
O
N
T
A
C
T
S



32-73
46
16

4
7
C
O
N
T
A
C
T
S



36-7
47
7-12, 40-16



36-8
47
1-12, 46-16

INSERT ARRANGEMENT:
NUMBER OF CONTACTS:
SIZE OF CONTACTS:

100° ROTATION OF 36-7

36-16
47
7-12, 40-16

250° ROTATION OF 36-7

36-17
47
7-12, 40-16

40-9
47
1-8, 22-12, 24-16

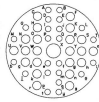
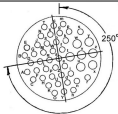
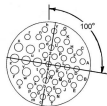

MTMS-E CONNECTORS

Specification MIL-C-5015C combined the performance requirements of moistureproof and vibration resistant characteristics. The result is the Type "E" (Environment Resisting) connector. This series of connectors are suitable for those applications which are subject to high vibration and the outdoor elements.

Shell components;

Fabricated from high grade aluminum alloys and cadmium plated per QQ-P-416 with olive drab chromate after treatment.

Contacts;

Are SILVER plated solder type with closed entry design in size 16 socket.

Inserts;

Are per MIL-R-3065 for maximum vibration and moisture resistance.

Clamp Assembly;

Provides a positive mechanical moisture seal and strain relief.



MTMSE 0 WALL MOUNTING RECEPTACLE

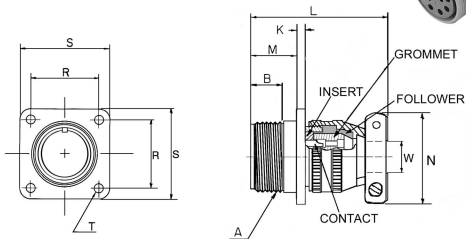

Shell Size	A Thread Class 2A	B Min Full Thd	K		L Max	M $\pm .031$ $-.000$	N Max	R $\pm .005$	S $\pm .031$	T $\pm .010$ $-.005$	W CABLE MAX		
			Max	Min									
8S	.5000-28UNEF	.391	.156	.062	2.054	.562	1.045	.594	.875	.120	.250		
10S	.6250-24NEF				2.223			.719	1.000				
10SL	.6250-24NEF	.450			2.598	.750	1.125	.812	1.094				
12S	.7500-20UNEF	.625											
12	.7500-20UNEF	.450			2.223	.562	1.340	.906	1.188				
14S	.8750-20UNEF	.625											
14	.8750-20UNEF	.450			2.598	.750	1.487	.969	1.281				
16S	1.0000-20UNEF	.450											
16	1.0000-20UNEF	.450			2.223	.562	.750	1.600	1.062		1.375		
18	1.1250-18NEF	2.598											
18	1.1250-18NEF	.625	.203	.094	2.630	.812	2.000	1.375	1.750	.147	.625		
20	1.2500-18NEF	2.740			1.890						1.250	1.625	
20	1.2500-18NEF	.450				2.803	2.000	1.375	1.750				
22	1.3750-18NEF	.625											
22	1.3750-18NEF	.450			3.019	2.125	1.562	2.000					
24	1.5000-18NEF	.625											
24	1.5000-18NEF	.450			3.004	.875	2.650	1.750	2.250				
28	1.7500-18NS	.625											
28	1.7500-18NS	.450			.359	.125	3.222	2.875	1.938		2.500	.173	1.250
32	2.0000-18NS	.450											
32	2.0000-18NS	.450	.359	.125	3.222	2.875	1.938	2.500	.173	1.355			
36	2.2500-16UN	.450											
36	2.2500-16UN	.450	.359	.125	3.222	2.875	1.938	2.500	.173	1.562			
40	2.5000-16UN	.450											

RHIMCO'S EXAMPLE PART NUMBER

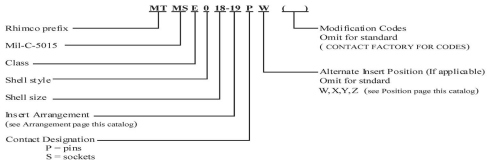

16
CONTACTS17
CONTACTS

INSERT ARRANGEMENT: 32-68
 NUMBER OF CONTACTS: 16
 SIZE OF CONTACTS: 12-16, 4-4 (COAX) RG-58CU

36-14
 16
 5-8, 5-12, 6-16

20-29
 17
 16

36-13
 17
 2-12, 15-16

19
CONTACTS20
CONTACTS22
CONTACTS

INSERT ARRANGEMENT: 22-14
 NUMBER OF CONTACTS: 19
 SIZE OF CONTACTS: 16

28-16
 20
 16

28-11
 22
 4-12, 18-16

35-1
 22
 4-12, 18-16

23
CONTACTS100° ROTATION
OF 32-6

INSERT ARRANGEMENT: 32-6
 NUMBER OF CONTACTS: 23
 SIZE OF CONTACTS: 2-4, 3-8, 2-12, 16-16

32-13
 23
 5-12, 8-16

32-16
 23
 2-4, 3-8, 2-12, 16-16

24-28
 24
 16

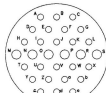
26
CONTACTS30
CONTACTS

INSERT ARRANGEMENT: 26-12
 NUMBER OF CONTACTS: 26
 SIZE OF CONTACTS: 16

100° ROTATION OF 28-12
 28-13
 26
 16

32-8
 30
 6-12, 24-16

40-1
 30
 6-12, 24-16

INSERT ARRANGEMENTS Layouts

All views are looking into front of Pin Insert or rear of Socket Insert in normal position.

1
2
CONTACTS



28-18
12
16



28-51
12
12



IDENTICAL TO 28-51
EXCEPT FOR KEYWAY
28-54
12
12

1
3
CONTACTS



20-11
13
16

INSERT ARRANGEMENT:
NUMBER OF CONTACTS:
SIZE OF CONTACTS:



100° ROTATION
OF 20-11

20-25
13
16



250° ROTATION
OF 20-11

20-30
13
16



24-58
13
3-8, 3-12, 7-16

1
4
CONTACTS



20-27
14
16



22-19
14
16

INSERT ARRANGEMENT:
NUMBER OF CONTACTS:
SIZE OF CONTACTS:



28-2
14
2-12, 12-16



28-20
14
10-12, 12-16



32-4
14
2-12, 12-16



32-9
14
2-4, 12-16

INSERT ARRANGEMENT:
NUMBER OF CONTACTS:
SIZE OF CONTACTS:

1
5
CONTACTS



28-17
15
16



32-12
15
5-12, 10-16

1
6
CONTACTS



24-5
16
16



24-7
16
2-12, 14-16

INSERT ARRANGEMENT:
NUMBER OF CONTACTS:
SIZE OF CONTACTS:



MTMSE 1 CABLE CONNECTING PLUG

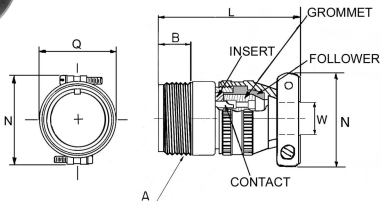

Shell Size	A Thread Class 2A	B Min Full Thd	L Max	N Max	W CABLE MAX	Q Max
8S	.5000-28UNEF	.391	2.223	1.045	.250	.562
10S	.6250-24NEF					.640
10SL						
12S	.7500-20UNEF	.450	2.598	1.125	.305	.760
12		.625				
14S	.8750-20UNEF	.450	2.223	1.340	.437	.875
14		.625	2.598			
16S	1.0000-20UNEF	.450	2.223	1.487	.555	1.031
16			2.598			
18	1.1250-18NEF	.625	2.630	1.600	.625	1.150
20	1.2500-18NEF		2.740	1.875	.750	1.265
22	1.3750-18NEF			1.890		1.421
24	1.5000-18NEF		2.803	2.000	.930	1.562
28	1.7500-18NS		3.019	2.125		1.781
32	2.0000-18NS		3.004	2.650	1.250	2.000
36	2.2500-16UN			2.875	1.355	2.250
40	2.5000-16UN		3.222	3.500	1.562	2.500

RHIMCO'S EXAMPLE PART NUMBER

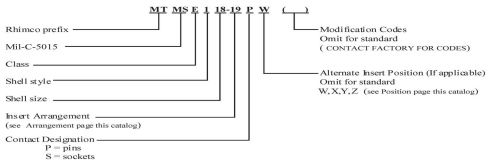

MTMS(E,F, or R) 2 BOX MOUNTING RECEPTACLE

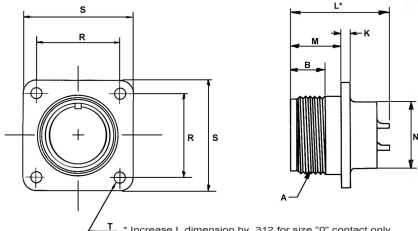

Shell Size	A Thread Class 2A	B Min Full Thd	K Max	Min	*L Max	M +.031 -0.00	N +0.00 -0.020	R +.005	S +.031	T +0.10 -0.005					
8S	.5000-28UNEF	.391	.156	.062	1.191	.562	.532	.594	.875	.120					
10S	.6250-24NEF						.479	.719	1.000						
10SL		.640													
12S	.7500-20UNEF	.450			1.713	.750	.604	.812	1.094						
12		.625					1.191	.562	.738		.906	1.188			
14S	.8750-20UNEF	.450			1.713	.750	1.191	.562	.864		.969	1.281			
14		.625					1.713		.988		1.062	1.375			
16S	1.0000-20UNEF	.450					.750		1.135		1.156	1.500			
16									1.260		1.250	1.625			
18	1.1250-18NEF	.625			.203	.094	1.750	.812	1.385		1.375	1.750	.147		
18	1.2500-18NEF		1.604	1.562					2.000						
20	1.2500-18NEF		1.854	1.750					2.250						
22	1.3750-18NEF		2.041	1.938					2.500						
24	1.5000-18NEF		2.291	2.188					2.750						
24	1.5000-18NEF		2.782	2.375					3.000						
28	1.7500-18NS									2.291	2.188	2.750			.173
32	2.0000-18NS									2.782	2.375	3.000			
36	2.2500-16UN									3.032	2.625	3.250			
40	2.5000-16UN														
44	2.75000-16UN														
48	3.0000-16UN														

RHIMCO'S EXAMPLE PART NUMBER

MT MSE 2 18-19 P W ()

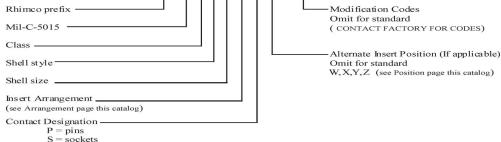

INSERT ARRANGEMENTS

Layouts

All views are looking into front of Pin Insert or rear of Socket Insert in normal position.

9
CONTACTS



INSERT ARRANGEMENT:
NUMBER OF CONTACTS:
SIZE OF CONTACTS:

20-16
9
2-12, 7-16

20-18
9
3-12, 6-16

20-21
9
1-12, 8-16

22-16
9
3-12, 6-16

22-17
9
1-12, 8-16

22-20
9
16



INSERT ARRANGEMENT:
NUMBER OF CONTACTS:
SIZE OF CONTACTS:

22-27
9
1-8, 9-16

24-11
9
3-8, 6-12

28-1
9
3-8, 6-12

28-4
9
2-12, 7-16

28A-16
9
4-4, 5-16



10
CONTACTS



INSERT ARRANGEMENT:
NUMBER OF CONTACTS:
SIZE OF CONTACTS:

32-9
14
2-4, 12-16

18-1
10
16

18-19
10
16

250° ROTATION
OF 18-1
18-24
10
16

24-S12
24
10-16, 2-4



11
CONTACTS



12
CONTACTS



INSERT ARRANGEMENT:
NUMBER OF CONTACTS:
SIZE OF CONTACTS:

24-21
10
1-8, 9-16

28-19
10
4-12, 6-16

20-33
11
16

24-20
11
2-12, 9-16

28-8
12
2-12, 10-16

INSERT ARRANGEMENTS Layouts

All views are looking into front of Pin Insert or rear of Socket Insert in normal position.

7
C
O
N
T
A
C
T
S



100° ROTATION
OF 18-9

INSERT ARRANGEMENT: 18-9
NUMBER OF CONTACTS: 7
SIZE OF CONTACTS: 2-12, 5-16

INSERT ARRANGEMENT: 18-17
NUMBER OF CONTACTS: 7
SIZE OF CONTACTS: 2-12, 5-16

INSERT ARRANGEMENT: 20-15
NUMBER OF CONTACTS: 7
SIZE OF CONTACTS: 12

INSERT ARRANGEMENT: 22-28
NUMBER OF CONTACTS: 7
SIZE OF CONTACTS: 12

INSERT ARRANGEMENT: 22-33
NUMBER OF CONTACTS: 7
SIZE OF CONTACTS: 16

INSERT ARRANGEMENT: 24-2
NUMBER OF CONTACTS: 7
SIZE OF CONTACTS: 12



INSERT ARRANGEMENT: 24-3
NUMBER OF CONTACTS: 7
SIZE OF CONTACTS: 2-12, 5-16

INSERT ARRANGEMENT: 24-10
NUMBER OF CONTACTS: 7
SIZE OF CONTACTS: 1-8, 3-12, 3-16

INSERT ARRANGEMENT: 24-16
NUMBER OF CONTACTS: 7
SIZE OF CONTACTS: 16

INSERT ARRANGEMENT: 24-27
NUMBER OF CONTACTS: 7
SIZE OF CONTACTS: 16

INSERT ARRANGEMENT: 28-10
NUMBER OF CONTACTS: 7
SIZE OF CONTACTS: 2-4, 2-8, 3-12



8
C
O
N
T
A
C
T
S



INSERT ARRANGEMENT: 32-10
NUMBER OF CONTACTS: 7
SIZE OF CONTACTS: 2-4, 2-8, 3-16

INSERT ARRANGEMENT: 18-8
NUMBER OF CONTACTS: 8
SIZE OF CONTACTS: 1-12, 7-16

INSERT ARRANGEMENT: 20-7
NUMBER OF CONTACTS: 8
SIZE OF CONTACTS: 16

INSERT ARRANGEMENT: 20-9
NUMBER OF CONTACTS: 8
SIZE OF CONTACTS: 1-12, 7-16

INSERT ARRANGEMENT: 20-18
NUMBER OF CONTACTS: 9
SIZE OF CONTACTS: 3-12, 6-16

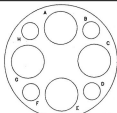

INSERT ARRANGEMENT: 22-23
NUMBER OF CONTACTS: 8
SIZE OF CONTACTS: 12

INSERT ARRANGEMENT: 22-36
NUMBER OF CONTACTS: 8
SIZE OF CONTACTS: A,C,E,G - IRON
B,D,F,H - CONSTANTAN
12

INSERT ARRANGEMENT: 24-6
NUMBER OF CONTACTS: 8
SIZE OF CONTACTS: 12

INSERT ARRANGEMENT: 32-15
NUMBER OF CONTACTS: 8
SIZE OF CONTACTS: 2-0, 6-12

INSERT ARRANGEMENT: 40-ADS
NUMBER OF CONTACTS: 8
SIZE OF CONTACTS: 4-0, 4-8

MTMSE 8 90-DEGREE PLUG

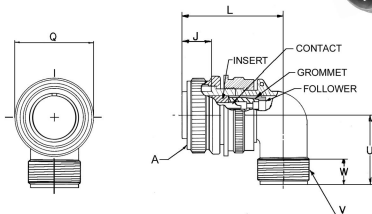

Shell Size	A Thread Class 2A	J +/- .005	L Max	Q Max	U	V Thread Class 2A	W Min
8S	.5000-28UNEF	.531	1.427	.750	.750	.5000-28UNEF	.375
10S	.6250-24NEF		1.458	.945			
10SL	.6250-24NEF		1.482				
12S	.7500-20UNEF	.719	1.487	.995	.875	.6250-24NEF	
12	.7500-20UNEF		1.862				
14S	.8750-20UNEF	.531	1.651	1.125	1.000	.7500-20UNEF	
14	.8750-20UNEF	.719	1.926				
16S	1.0000-20UNEF	.531	1.677	1.250	1.062	.8750-20UNEF	
16	1.0000-20UNEF		2.051				
18	1.1250-18NEF	.719	2.114	1.344	1.188	1.0000-20UNEF	
20	1.2500-18NEF		2.364	1.469	1.250	1.1875-18NEF	
22	1.3750-18NEF		1.594	1.312			
24	1.5000-18NEF		2.615	1.719	1.438	1.4375-18NEF	
28	1.7500-18NEF		1.969	1.500			
32	2.0000-18NS		2.837	2.219	1.750	1.7500-18NS	
36	2.2500-16UN		2.895	2.469	1.875	2.0000-18NS	
40	2.5000-16UN		3.020	2.719	2.031	2.2500-16UN	.500

RHIMCO'S EXAMPLE PART NUMBER

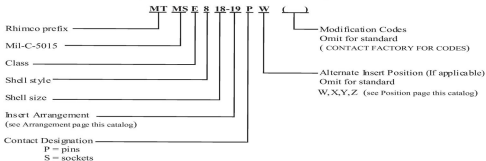

INSERT ARRANGEMENTS

Layouts

All views are looking into front of Pin Insert or rear of Socket Insert in normal position.

5
C
O
N
T
A
C
T
S



INSERT ARRANGEMENT:
NUMBER OF CONTACTS:
SIZE OF CONTACTS:

22-12
5
2-6, 3-16

22-13
5
4-12, 1-16

22-34
5
3-12, 2-16

24-12
5
2-4, 3-12

24-17
5
2-12, 3-16

24-79
5
8



6
C
O
N
T
A
C
T
S



INSERT ARRANGEMENT:
NUMBER OF CONTACTS:
SIZE OF CONTACTS:

28-5
5
2-4, 1-12, 2-16

32-1
5
2-0, 3-12

32-2
5
3-4, 2-16

14S-6
6
16

18-12
6
16



INSERT ARRANGEMENT:
NUMBER OF CONTACTS:
SIZE OF CONTACTS:

20-6
6
2-6, 4-16

20-17
6
5-12, 1-16

20-22
6
3-8, 3-16

22-5
6
2-12, 4-16

22-15
6
5-12, 1-16

22-24
6
2-12, 4-16

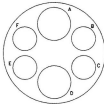
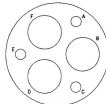

7
C
O
N
T
A
C
T
S



INSERT ARRANGEMENT:
NUMBER OF CONTACTS:
SIZE OF CONTACTS:

28-22
6
3-4, 3-16

36-3
6
3-0, 3-12

36-6
6
2-0, 4-4

16S-1
7
16

INSERT ARRANGEMENTS Layouts

All views are looking into front of Pin Insert or rear of Socket Insert in normal position.

4 CONTACTS

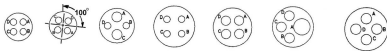

100° ROTATION
of 14S-2

INSERT ARRANGEMENT:
NUMBER OF CONTACTS:
SIZE OF CONTACTS:

14S-2	14S-10	16-9	18-4	18-10	18-13	18-15
4	4	4	4	4	4	4; A, C - Iron; B, D - Constantan
1C	16	2-12, 2-16	16	12	1-8, 3-12	12



INSERT ARRANGEMENT:
NUMBER OF CONTACTS:
SIZE OF CONTACTS:

20-4	20-20	20-24	22-4	22-10	22-22
4	4	4	4	4	4
12	1-4, 3-12	2-8, 2-16	2-8, 2-12	16	8

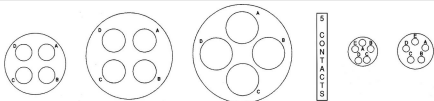

INSERT ARRANGEMENT:
NUMBER OF CONTACTS:
SIZE OF CONTACTS:

24-22	32-17	36-5	14S-5	16S-8
4	4	4	5	5
8	4	0	16	16

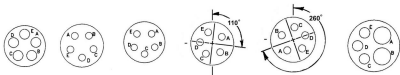

110° ROTATION
of 18-20

260° ROTATION
of 18-20

INSERT ARRANGEMENT:
NUMBER OF CONTACTS:
SIZE OF CONTACTS:

18-11	18-20	18-29	18-30	18-31	20-14
5	5	5	5	5	5
12	16	16	16	16	2-8, 3-12

MTMS-F CONNECTORS

Specification MIL-C-5015C combined the performance requirements of moistureproof and vibration resistant characteristics. The result is the Type "F" (Environment Resisting) connector. This series of connectors are suitable for those applications which are subject to high vibration and the outdoor elements. The MTMSF6 and MTMSF8 connectors incorporate a seal over the Plug Barrel providing a moisture seal in the mated condition.

Shell components;

Fabricated from high grade aluminum alloys and cadmium plated per QQ-P-416 with olive drab chromate after treatment.

Contacts;

Are solder type, closed entry probe resistant design on size 16 socket and are silver plated soldered.

Inserts;

Are per MIL-R-3065 for maximum vibration and moisture resistance.

Clamp Assembly;

Provides a positive mechanical moisture seal and strain relief.



MTMSF 0 WALL MOUNTING RECEPTACLE

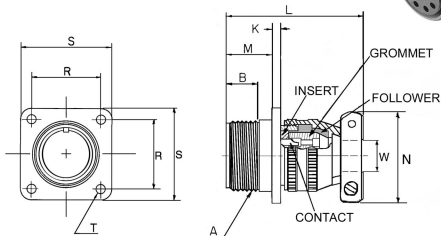

Shell Size	A Thread Class 2A	B Min Full Thd	K Max Min		L Max	M +.031 -.000	N Max	R +/- .005	S +/- .031	T +.010 -.005	W CABLE MAX
8S	.5000-28UNEF				2.054		1.045	.594	.875		.250
10S	.6250-24NEF	.391			2.223	.562		.719	1.000		
10SL							1.125				.305
12S	.7500-20UNEF	.450			2.598	.750		.812	1.094		
12		.625	.156	.062	2.223	.562				.120	.437
14S	.8750-20UNEF	.450			2.598	.750	1.340	.906	1.188		
14		.625			2.223	.562					.555
16S	1.0000-20UNEF	.450			2.598	.750	1.487	.969	1.281		
16					2.598						.625
18	1.1250-18NEF				2.630		1.600	1.062	1.375		
20	1.2500-18NEF				2.740	.750	1.875	1.156	1.500		.750
22	1.375-18NEF		.203	.094			1.890	1.250	1.625		
24	1.5000-18NEF	.625			2.803	.812	2.000	1.375	1.750		
28	1.7500-18NS				3.019		2.125	1.562	2.000	.147	.930
32	2.0000-18NS				3.004		2.650	1.750	2.250		1.250
36	2.2500-16UN		.359	.125		.875	2.875	1.938	2.500	.173	1.355
40	2.5000-16UN				3.222		3.500	2.188	2.750		1.562

RHIMCO'S EXAMPLE PART NUMBER

MT MS F 0 18-12 P W ()

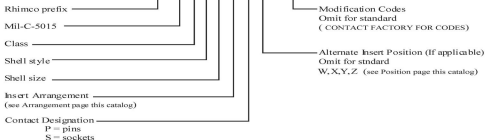

INSERT ARRANGEMENTS

Layouts

All views are looking into front of Pin Insert or rear of Socket Insert in normal position.

CONTACTS



CONTACTS



INSERT ARRANGEMENT:
NUMBER OF CONTACTS:
SIZE OF CONTACTS:

22-11
2
16

24-9
2
4

28-7
2
4

32-5
2
0

108L-3
3
16

145-1
3
16



100° ROTATION
of 145-1

INSERT ARRANGEMENT:
NUMBER OF CONTACTS:
SIZE OF CONTACTS:

14S-7
3
16

14S-12
3
16

16S-5
3
16

16S-6
3
16

16-7
3
1-8, 2-16

16-10
3
12

18-5
3
2-12, 1-16



INSERT ARRANGEMENT:
NUMBER OF CONTACTS:
SIZE OF CONTACTS:

18-22
3
16

20-3
3
12

20-6
3
16

20-19
3
8

22-2
3
8

22-6
3
2-8, 1-16

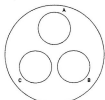

INSERT ARRANGEMENT:
NUMBER OF CONTACTS:
SIZE OF CONTACTS:

22-9
3
12

22-21
3
1-0, 2-16

28-3
3
8

28-6
3
4

36-4
3
0

INSERT ARRANGEMENTS Layouts

All views are looking into front of Pin Insert or rear of Socket Insert in normal position.

1
C
O
N
T
A
C
T



INSERT ARRANGEMENT:	8S-1	10S-2	12S-4	12-5	14S-4	14-3	16S-3	16-2
NUMBER OF CONTACTS:	1	1	1	1	1	1	1	1
SIZE OF CONTACTS:	16	16	16	12	16	8	16	12



INSERT ARRANGEMENT:	16-12	18-6	18-7	18-16	20-2	22-7
NUMBER OF CONTACTS:	1	1	1	1	1	1
SIZE OF CONTACTS:	4	4	8	12	0	0

2
C
O
N
T
A
C
T
S



250° ROTATION
of 12S-3

INSERT ARRANGEMENT:	10SL-4	12S-2	12S-3	14S-9	16S-4	16-11	16-13
NUMBER OF CONTACTS:	2	2	2	2	2	2	2, A=IRON, B=CONSTANTAN
SIZE OF CONTACTS:	16	16	16	16	16	12	12



INSERT ARRANGEMENT:	18-3	18-14	20-12	20-23	22-1	22-8
NUMBER OF CONTACTS:	2	2	2	2	2	2
SIZE OF CONTACTS:	12	1-4, 1-16	1-4, 1-16	8	8	12



MTMSF 1 CABLE CONNECTING PLUG

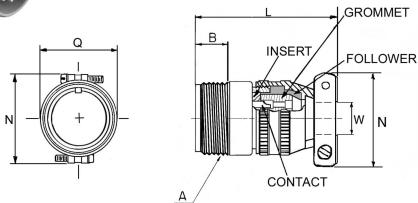

Shell Size	A Thread Class 2A	B Min Full Thd	L Max	N Max	W CABLE MAX	Q Max	
8S	.5000-28UNEF	.391	2.223	1.045	.250	.562	
10S	.6250-24NEF					.640	
10SL							
12S	.7500-20UNEF	.450	2.598	1.125	.305	.760	
12		.625					
14S	.8750-20UNEF	.450	2.223	1.340	.437	.875	
14		.625	2.598				
16S	1.0000-20UNEF	.450	2.223	1.487	.555	1.031	
16			2.598				
18	1.1250-18NEF	.625	2.630	1.600	.625	1.150	
20	1.2500-18NEF		2.740	1.875	.750	1.265	
22	1.3750-18NEF			1.890		1.421	
24	1.5000-18NEF		2.803	2.000	.930	1.562	
28	1.7500-18NS		3.019	2.125		1.781	
32	2.0000-18NS		3.004	2.650	1.250	2.000	
36	2.2500-16UN			2.875	1.355	2.250	
40	2.5000-16UN			3.222	3.500	1.562	2.500

RHIMCO'S EXAMPLE PART NUMBER

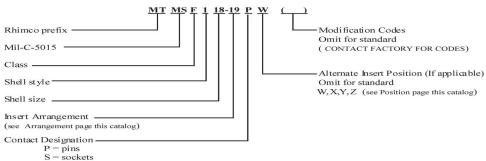

MTMSF 6 STRAIGHT PLUG

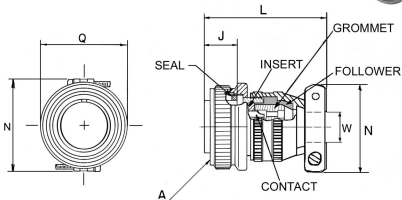

Shell Size	A Thread Class 2B	J ±.005	L Max	N Max	Q Max	W CABLE MAX
8S	.5000-28UNEF	.531	1.543	1.045	.750	.250
10S	.6250-24NEF		1.691		.945	
10SL			1.686			
12S	.7500-20UNEF	.719	1.691	1.125	.995	.305
12			1.878			
14S	.8750-20UNEF	.531	1.691	1.340	1.125	.437
14			.719			
16S	1.0000-20UNEF	.531	1.691	1.487	1.250	.555
16			1.878			
18	1.1250-18NEF	.719	1.910	1.600	1.344	.625
20	1.2500-18NEF		2.020	1.875	1.469	.750
22	1.3750-18NEF		2.083	1.890	1.594	
24	1.5000-18NEF		2.083	2.000	1.719	.930
28	1.75000-18NS		2.301	2.125	1.969	
32	2.0000-18NS		2.284	2.650	2.219	
36	2.2500-16UN	2.502	2.875	2.469	1.355	1.355
40	2.5000-16UN		3.500	2.719	1.562	

RHIMCO'S EXAMPLE PART NUMBER

MT MS F 6 18-19 P W ()

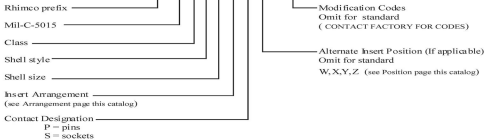

NOTES

This Page Intentionally left blank

INSERT ARRANGEMENT SELECTION GUIDE

ARRANGEMENT NUMBER	SERVICE RATING	TOTAL CONTACTS	CONTACT SIZE				
			0	4	8	12	16
22-23	D : A	8				8	
22-24	D : A	6				2	4
22-27	D : A	9			1		8
22-28	A	7				7	
22-33	D : A	7					7
22-34	D	5				3	2
22-36	D : A	8					8
24-S12	INST	24	2				10
24-2	D	7				7	
24-3	D	7				2	5
24-5	A	16					16
24-6	D : A	8					8
24-7	A	16					2
24-9	A	2	2				
24-10	A	7				7	
24-11	A	9				3	6
24-12	A	5	2			3	
24-16	D : A	7		1	3	3	
24-17	D	5				2	3
24-20	D	11				2	9
24-21	D	10			1		9
24-22	D	4			4		
24-27	E	7					7
24-28	INST	24					24
24-58	A	13			3	3	7
24-79	A	5			5		
28-1	D : A	9			3	6	
28-2	D	14				2	12
28-3	E	3			3		
28-4	E : D	9				2	7
28-5	D	5	2			1	2
28-6	D	3			3		
28-7	D	2			2		
28-8	D : A	12				2	10
28-9	D	12				6	6
28-10	D : A	7			2	2	3
28-11	A	22				4	18
28-12	A	26					26
28-13	A	26					26
28-15	A	35					35
28-16	A	20					20
28-17	R : D : A	15					15
28-18	M : D : H : INST	12					12
28-19	B : D : A	10				4	6
28-20	A	14				10	4
28-21	A	37					37
28-22	D	6			3		3
28A-16	A	9			4		5
28-51	A	12					12
28-54	A	12					12

ARRANGEMENT NUMBER	SERVICE RATING	TOTAL CONTACTS	CONTACT SIZE				
			0	4	8	12	16
32-1	A : D	5				2	3
32-2	E	5				3	2
32-3	D	9			1	2	2
32-4	A : D	14					2
32-5	D	2			2		
32-6	A	23				2	3
32-7	INST : A	35					7
32-8	A	30					6
32-9	D	14				2	
32-10	E : B : D : A	7				2	2
32-12	A : D	15					5
32-13	D	23					5
32-15	D	8			2		6
32-16	A	23				2	3
32-17	D	4					4
32-59							
32-64	INST	54					54
32-68	A	16				4	
32-73	A	46					46
35-1	D	22					4
35-3	D	6				3	
35-4	D : A	3				3	
35-5	A	4				4	
35-6	A	6				2	4
35-7	A	47					7
35-8	A	47					1
35-9	A	31				1	2
35-10	A	48					14
35-11	A	48					48
35-12	A	48					48
35-14	D	16					5
35-15	D : A	35					5
35-16	A	47					7
35-17	A	47					7
35-18	A	31				1	2
35-20	A	34				2	2
35-52	A	52					30
35A-95	INST	65					52
40-1	D	30					6
40-9	A	47				1	22
40-56	A	85					24
40-ADS	A	8				4	4
44-52	A	104					85
48-62	D	85					

Consult factory for additional military approved and special commercial insert arrangements.



MTMSF 8 90-DEGREE PLUG

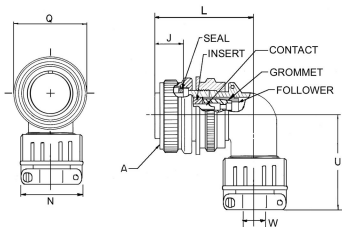

Shell Size	A Thread Class 2A	J +/- .005	L Max	Q Max	N Max	U Max	W CABLE MAX
8S	.5000-28UNEF	.531	1.427	.750	.843	1.469	.250
10S	.6250-24UNEF		1.458	.945			
10SL			1.482				
12S	.7500-20UNEF	.719	1.487	.995	.906	1.500	.312
12			1.862				
14S	.8750-20UNEF	.531	1.651	1.125	1.093	1.594	.438
14		.719	1.926				
16S	1.0000-20UNEF	.531	1.677	1.250	1.187	1.688	.562
16			2.051				
18	1.1250-18NEF	.719	2.114	1.344	1.281	1.781	.625
20	1.2500-18NEF		2.364	1.469	1.500	1.969	.750
22	1.3750-18NEF		1.594	2.000			
24	1.5000-18NEF		1.719	2.125	1.719	2.188	.938
28	1.7500-18NEF		1.969	2.188			
32	2.0000-18NS		2.837	2.219	2.062	2.594	1.250
36	2.2500-16UN		2.895	2.469	2.312	2.719	1.375
40	2.5000-16UN		3.020	2.719	2.719	4.730	1.625

RHIMCO'S EXAMPLE PART NUMBER

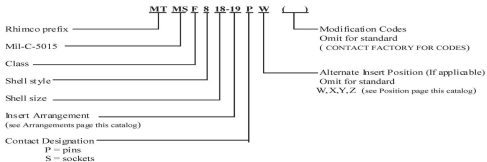

MTMS-R CONNECTORS

The MTMS-R is a shorter and lighter type connector. It is environmental resisting with the addition of a seal over the Plug barrel of the MTMSR6 straight plug providing a moisture-proof seal when in the mated condition.

Shell components;

Are fabricated from high grade aluminum alloys and cadmium plated per QQ-P-416 Type II Class 3. Olive drab chromate after treatment.

Contacts;

The size 16 contacts have a closed-entry probe resistant design and all are silver plated for maximum corrosion resistance.

Insert;

Per MIL-R-3065 for maximum vibration resistance and high dielectric strength.



INSERT ARRANGEMENT SELECTION GUIDE

ARRANGEMENT NUMBER	SERVICE RATING	TOTAL CONTACTS	CONTACT SIZE				
			0	4	8	12	16
8S-1	A	1					1
10S-2	A	1					1
10SL-3	INST : A	3					3
10SL-4	A	2					2
12S-2	A	2					2
12S-3	A	2					2
12S-4	D	1					1
12-5	D	1			1		
14S-1	A	3					3
14S-2	INST	4					4
14S-4	D	1					1
14S-5	INST	5					5
14S-6	INST	6					6
14S-7	A	3					3
14S-9	A	2					2
14S-10	INST	4					4
14S-12	A	3					3
14-3	A	1		1			
16S-1	A	7					7
16S-3	B	1					1
16S-4	D	2					2
16S-5	A	3					3
16S-6	A	3					3
16S-8	A	5					5
16-2	E	1			1		
16-7	A	3		1			2
16-9	A	4			2		2
16-10	A	3			3		
16-11	A	2			2		
16-12	A	1		1			
16-13	A	2			2		
18-1	INST : A	10					10
18-3	D	2			2		
18-4	D	4					4
18-5	D	3			2		1
18-6	D	1		4			
18-7	B	1		1			
18-8	A	8			1		7
18-9	INST	7			2		5
18-10	A	4			4		
18-11	A	5			5		
18-12	A	6					6
18-13	A	4			1	3	
18-14	A	2		1			1
18-15	A	4			4		
18-16	C	1			1		
18-17	INST	7			2		5
18-19	A	10					10
18-20	A	5					5
18-22	D	3					3

ARRANGEMENT NUMBER	SERVICE RATING	TOTAL CONTACTS	CONTACT SIZE				
			0	4	8	12	16
18-24	INST : A	10					10
18-29	A	5					5
18-30	A	5					5
18-31	A	5					5
20-2	D	1	1				
20-3	D	3					3
20-4	D	4					4
20-6	D	3					3
20-7	D : A	8					8
20-8	INST	6			2		4
20-9	D : A	8				1	7
20-11	INST	13					13
20-12	A	2		1			1
20-14	A	5			2	3	
20-15	A	7					7
20-16	A	9				2	7
20-17	A	6					5
20-18	A	9				3	6
20-19	A	3			3		
20-20	A	4		1		3	
20-21	A	9				1	8
20-22	A	6			3		3
20-23	A	2			2		
20-24	A	4			2		2
20-25	INST	13					13
20-27	A	14					14
20-29	A	17					17
20-30	INST	13					13
20-33	A	11					11
22-1	D	2			2		
22-2	D	3			3		
22-4	A	4			2	2	
22-5	D	6				2	4
22-6	D	3			2		1
22-7	E	1	1				
22-8	E	2				2	
22-9	E	3				3	
22-10	E	4					4
22-11	B	2					2
22-12	D	5			2		3
22-13	D : A	5				4	1
22-14	A	19					19
22-15	E : A	6				5	1
22-16	A	9				3	6
22-17	D : A	9				1	8
22-18	D : A	8					8
22-19	A	14					14
22-20	A	9					9
22-21	A	3	1				2
22-22	A	4			4		

Consult factory for additional military approved and special commercial insert arrangements.

ALTERNATE KEYING POSITION

Mil-C-5015 specifications provide for "Alternate Arrangements", which means that the connector insert is rotated, with respect to the shell, a specified number of degrees from the normal position. This is to prevent mismatching when there are several connectors the same size installed close to one another.

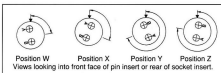

As shown in Mil-C-5015, alternate arrangements positions are identified by the letters W, X, Y, and Z. These letters are added as a suffix to the normal part number.

ARRANGEMENT NUMBER	KEYING POSITION (DEGREES FROM NORMAL POSITION)			
	W	X	Y	Z
12S-3	70	145	215	280
14S-2	-	120	240	-
14S-5	-	110	-	-
14S-7	90	180	270	-
14S-9	70	145	215	280
16S-1	80	-	-	280
16S-4	35	110	250	325
16S-5	70	145	215	280
16S-6	90	180	270	-
16S-8	-	170	265	-
16S-7	80	110	250	280
16-9	35	110	250	325
16-10	90	180	270	-
16-11	35	110	250	325
16-13	35	110	250	325
18-1	70	145	215	280
18-3	35	110	250	325
18-4	35	110	250	325
18-5	80	110	250	280
18-8	70	-	-	280
18-9	80	110	250	280
18-10	-	120	240	-
18-11	-	170	265	-
18-12	80	-	-	280
18-13	80	110	250	280
18-14	80	110	250	280
18-15	-	120	240	-
18-19	-	120	240	-
18-20	90	180	270	-
18-22	70	145	215	290
18-29	90	180	270	-
20-3	70	145	215	290
20-4	45	110	250	-
20-6	70	145	215	280
20-7	80	110	250	280
20-8	80	110	250	280
20-9	80	110	250	280
20-12	80	110	250	280
20-14	80	110	250	280
20-15	80	-	-	280
20-16	80	110	250	280
20-17	90	180	270	-
20-18	35	110	250	325
20-19	90	180	270	-
20-20	80	110	250	280
20-21	35	110	250	325
20-22	80	110	250	280
20-23	35	110	250	325
20-24	35	110	250	325

ARRANGEMENT NUMBER	KEYING POSITION (DEGREES FROM NORMAL POSITION)			
	W	X	Y	Z
20-27	35	110	250	325
20-29	80	-	-	280
22-1	35	110	250	325
22-2	70	145	215	290
22-4	35	110	250	325
22-5	35	110	250	325
22-6	80	110	250	280
22-8	35	110	250	325
22-9	70	145	215	290
22-10	35	110	250	325
22-11	35	110	250	325
22-12	80	110	250	280
22-13	35	110	260	325
22-14	80	110	250	280
22-15	80	110	250	280
22-16	80	110	250	280
22-17	80	110	250	280
22-18	80	110	250	280
22-19	80	110	250	280
22-20	35	110	250	325
22-21	80	110	250	280
22-22	-	110	250	-
22-23	35	-	250	-
22-24	80	110	250	280
22-27	80	-	250	280
22-28	80	-	-	280
22-33	80	110	250	280
22-34	80	110	250	280
22-36	90	-	270	-
24-2	80	-	-	280
24-3	80	110	250	280
24-5	80	110	250	280
24-6	80	110	250	280
24-7	80	110	250	280
24-9	35	110	250	325
24-10	80	-	-	280
24-11	35	110	250	325
24-12	80	110	250	280
24-16	80	110	250	280
24-17	80	110	250	280
24-20	80	110	250	280
24-21	80	110	250	280
24-22	45	110	250	-
24-27	80	-	-	280
24-28	80	110	250	280
28-1	80	110	250	280
28-2	35	110	250	325
28-3	70	145	215	290
28-4	80	110	250	280

ARRANGEMENT NUMBER	KEYING POSITION (DEGREES FROM NORMAL POSITION)			
	W	X	Y	Z
28-5	35	110	250	325
28-6	70	145	215	290
28-7	35	110	250	325
28-8	80	110	250	280
28-9	80	110	250	280
28-10	80	110	250	280
28-11	80	110	250	280
28-12	90	180	270	-
28-15	80	110	250	280
28-16	80	110	250	280
28-17	80	110	250	280
28-18	70	145	215	290
28-19	80	110	250	280
28-20	80	110	250	280
28-21	80	110	250	280
28-22	70	145	215	290
32-1	80	110	250	280
32-2	70	145	215	290
32-3	80	110	250	280
32-4	80	110	250	280
32-5	35	110	250	325
32-6	80	110	250	280
32-7	80	125	235	280
32-8	80	125	235	280
32-9	80	110	250	280
32-10	80	110	250	280
32-12	80	110	250	280
32-13	80	110	250	280
32-15	35	110	250	280
32-17	45	110	250	-
32-73	36	-	-	-
36-1	80	110	250	280
36-3	70	145	215	290
36-4	70	145	215	290
36-5	-	120	240	-
36-6	35	110	250	325
36-7	80	110	250	280
36-8	80	110	250	280
36-9	80	125	235	280
36-10	80	125	235	280
36-13	80	110	250	280
36-14	90	180	270	-
36-15	80	125	245	305
36-52	72	144	216	288
40-1	65	130	235	300
40-9	65	125	225	310
40-56	72	144	216	288
44-52	72	135	225	288
48-52	72	144	216	288



MTMSR 0 WALL MOUNTING RECEPTACLE

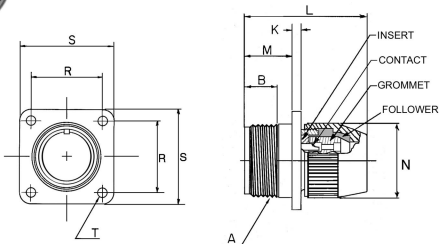

Shell Size	A Thread Class 2A	B Min Full Thd	K		L Max	M +.031 -.000	N Max	R +/- .005	S +/- .031	T +.010 -.005
			Max	Min						
8S	.5000-28UNEF	.391	.156	.062	1.838	.562	.500	.594	.875	.120
10S	.6250-24NEF						.6875	.719	1.000	
10SL										
12S	.7500-20UNEF						.450			
12		.625			2.181	.750				
14S	.8750-20UNEF	.450			1.838	.562	.937	.906	1.188	
14		.625			2.181	.750				
16S	1.0000-20UNEF	.450			1.838	.562				
16					2.181		1.015	.969	1.281	
18	1.1250-18NEF	.625	.203	.094	2.281	.750	1.140	1.062	1.375	.147
20	1.2500-18NEF						1.281	1.156	1.500	
22	1.375-18NEF						1.406	1.250	1.625	
24	1.5000-18NEF						1.531	1.375	1.750	
28	1.7500-18NS						1.781	1.562	2.000	
32	2.0000-18NS						2.031	1.750	2.250	
36	2.2500-16UN	.359	.125	2.322	.875	2.655	1.938	2.500	.173	
40	2.5000-16UN					3.000	2.188	2.750		

RHIMCO'S EXAMPLE PART NUMBER

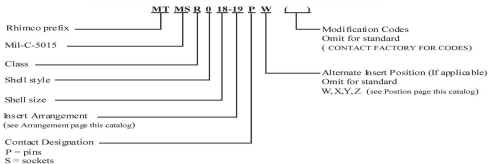

MTMSR 1 CABLE CONNECTING PLUG

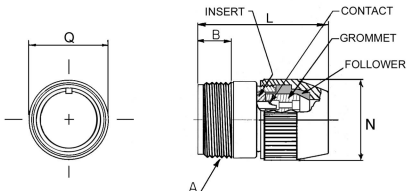

Shell Size	A Thread Class 2A	B Min Full thd	L Max	N Max Dia.	Q Max Dia.
8S	.5000-28UNEF	.375	1.838	.500	.562
10S	.6250-24NEF			.687	.640
10SL					
12S	.7500-20UNEF			.750	.750
12		.625	2.181		
14S	.8750-20UNEF	.375	1.838	.937	.875
14		.625	2.181		
16S	1.0000-20UNEF	.375	1.838	1.015	1.031
16			2.181		
18	1.1250-18NEF	.625	2.281	1.140	1.125
20	1.2500-18NEF			1.281	1.265
22	1.3750-18NEF			1.406	1.421
24	1.5000-18NEF			1.531	1.562
28	1.7500-18NS			1.781	1.781
32	2.0000-18NS			2.031	2.000
36	2.2500-16UN			2.655	2.250
40	2.5000-16UN			3.000	2.500

RHIMCO'S EXAMPLE PART NUMBER

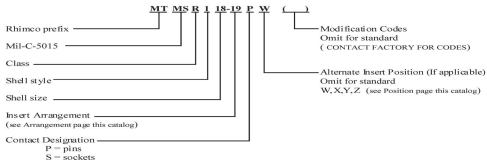

MT90470 CRIMP BUSHING

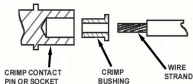

Contact Crimp Bushings are used to allow contacts to be crimped to wire smaller than the contact.

Example: MT90470-16 - used to adapt 16ga contacts to a 22ga wire. Consult factory for information.

THERMOCOUPLE TYPE CONTACTS

Consult factory for detailed ordering information

Thermocouple contacts come in a variety of materials iron, alumel, chromel, constantan and standard copper contacts. The use of standard shell components and resilient inserts are used.

IDENTIFICATION

For the purpose of wiring identification, the thermocouple contacts are marked in accordance with the following color code.

Chromel White
 Alumel Green
 Iron Black
 Constantan Yellow

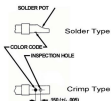

RECOMMENDED WIRE

I Chromel -- Alumel
 Use wire in accordance with AN-W-29

II Iron -- Constantan
 Use wire in accordance with AN-W-8b

WIRE WELL DATA

Contact Size	12	16
Well Inside Diameter	$+ .004$ $- .002$	$.125$ $.094$
Well Depth	$+ .031$ $- .000$	$.350$ $.188$
Solder Well Barrel Outside Diameter	$.166 \pm .003$	$.125 \pm .002$ $.004$

GASKETS

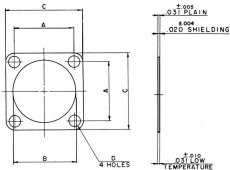

INSTALLATION DIMENSIONS					ORDER DATA		
HS SIZE SHELL	$\pm .010$	$\pm .010$	$\pm .010$	$\pm .010$	PLAIN	SHIELDING	LOW TEMPERATURE
	A	B	C	D			
85	.594	.500	.875	.172	MTMS0405-8	MTMS0405-8S	MTMS0675-8
105	.719	.625	1.000	.172	MTMS0405-10	MTMS0405-10S	MTMS0675-10
105L	.719	.625	1.000	.172			
125	.813	.750	1.094	.172	MTMS0405-12	MTMS0405-12S	MTMS0675-12
12	.813	.750	1.094	.172			
145	.906	.875	1.188	.172	MTMS0405-14	MTMS0405-14S	MTMS0675-14
14	.906	.875	1.188	.172			
165	.989	1.000	1.281	.172	MTMS0405-16	MTMS0405-16S	MTMS0675-16
16	.989	1.000	1.281	.172			
18	1.063	1.125	1.375	.203	MTMS0405-18	MTMS0405-18S	MTMS0675-18
20	1.156	1.250	1.500	.203	MTMS0405-20	MTMS0405-20S	MTMS0675-20
22	1.250	1.375	1.625	.203	MTMS0405-22	MTMS0405-22S	MTMS0675-22
24	1.375	1.500	1.750	.203	MTMS0405-24	MTMS0405-24S	MTMS0675-24
28	1.563	1.750	2.000	.203	MTMS0405-28	MTMS0405-28S	MTMS0675-28
32	1.750	2.000	2.250	.219	MTMS0405-32	MTMS0405-32S	MTMS0675-32
36	1.938	2.188	2.500	.219	MTMS0405-36	MTMS0405-36S	MTMS0675-36
40	2.188	2.438	2.750	.219	MTMS0405-40	MTMS0405-40S	MTMS0675-40



The plain flat gasket is made of synthetic rubber material. This gasket is designed to provide a waterproof and pressure seal when mated with a flange mounted receptacle.



The shielded flat gasket is designed to provide the maximum radio shielding under difficult conditions of high receiver sensitivity and low signal strength while retaining the sealing characteristics of the plain flat gasket when mated with a flange mounted receptacle.



The Low Temperature gasket is designed for those applications where the requirement is to be resistant to the effects of extremely low temperature. Even at temperature as low as -67 F, this gasket retains its resiliency and will seal a pressure differential of 30 PSI.

CONTACTS

Crimp Type (Solderless)

CONTACT PART NUMBER DATA		
SIZE	PIN CONTACT PART NUMBER	SOCKET CONTACT PART NUMBER
16 (SHORT)	MT5015CS-16P	MT5015CS-16S
16 (LONG)	MT5015CL-16P	MT5015CL-16S
12	MT5015CL-12P	MT5015CL-12S
8	MT5015CL-8P	MT5015CL-8S
4	MT5015CL-4P	MT5015CL-4S
0	MT5015CL-0P	MT5015CL-0S

Machined high grade copper alloy contacts are gold-plated for maximum corrosion resistance, (other finishes available), with a minimum millivolt drop and a maximum current carrying capacity. The size 16 socket contacts are of the closed entry design. Crimp type contact are available in all 5015 insert arrangement which contain contact size 0, 4, 8, 12, and / or 16.

CRIMP WELL DATA

Contact size	0	4	8	12	16
Well Diameter	.453 + .005	.281+ .005 - .004	.179+ .004 - .002	.098+ .004 - .002	.063+ .004 - .002
Well Depth	.750 + .031 - .000	.500	.500	.250	.250
Crimp Well Barrel Outside Diameter	.563 ± .005	.375+ .006 - .005	.271+ .004 - .003	.156+ .004 - .003	.103+ .004 - .003
Recommended Wire Size Per MIL-W-5086	0,*2	4,*6	8,*10	12,14	16,18, 20,22

* Indicated wire sizes can be crimped to listed contacts by using appropriate contact bushing.

ELECTRICAL DATA

The 5015 Service Data listed below illustrate the electrical ratings and physical spacing between the contacts and between the contacts and shell.

TABLE I

CONTACT RATING			
CONTACT SIZE	RATED CURRENT	TEST CURRENT	POTENTIAL DROP MILLIVOLTS MAX.
16	13	20	35
12	23	35	30
8	46	60	25
4	80	110	25
0	150	200	25

TABLE II

MS SERVICE	CONTACT ARRANGEMENT SERVICE RATING		
	RECOMMENDED OPERATING VOLTAGE ¹ AT SEA LEVEL	EFFECTIVE CREEPAGE DISTANCE	MECHANICAL SPACING NOM
INST.	DC	250	200
	AC RMS	250	200
A	700	500	1/8
D	1250	900	3/16
E	1750	1250	1/4
B	2450	1750	5/16
C	4200	3000	1

* The values listed in Table I represent operating values which include a generous safety factor. It may be necessary for some applications to exceed the operating voltages listed here. If this is necessary, designers will find Table II useful for determining the degree to which the recommended values of Table I can be exceeded.

ALTITUDE VOLTAGE DERATING** CHART

MS SERVICE RATING	NOMINAL DISTANCE		STANDARD SEA LEVEL CONDITIONS		PRESSURE ALTITUDE+ 80,000 FEET		PRESSURE ALTITUDE+ 70,000 FEET	
	AIRSPACE	CREEPAGE	MINIMUM FLASHOVER VOLTAGE VAC RMS	TEST VOLTAGE VAC RMS	MINIMUM FLASHOVER VOLTAGE VAC RMS	TEST VOLTAGE VAC RMS	MINIMUM FLASHOVER VOLTAGE VAC RMS	TEST VOLTAGE VAC RMS
INST	1/32	1/16	1400	1000	550	400	325	260
A	1/16	1/8	2800	2000	800	600	450	360
D	1/8	3/16	3600	2800	900	675	500	400
E	3/16	1/4	4500	3500	1000	750	550	440
B	1/4	5/16	5700	4500	1100	825	600	480
C	5/16	1	8500	7000	1300	975	700	560

+ Not corrected for changes in density due to variations in temperature.

**No attempt has been made to recommend operating voltages. The designer must determine his own operating voltages by application of a safety factor to the derating chart to compensate for circuit transients, surges, etc.



MTMSR 6 STRAIGHT PLUG

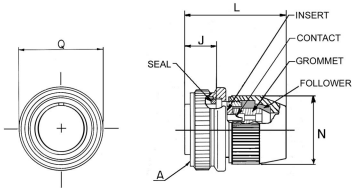

Shell Size	A Thread Class 2B	J +/- .005	L Max	Q Max	N Max
8S	.5000-28UNEF	.531	1.588	.750	.500
10S	.6250-24NEF			.945	.687
10SL					
12S	.7500-20UNEF	.719	1.931	.995	.750
12					
14S	.8750-20UNEF	.531	1.588	1.125	.937
14		.719	1.931		
16S	1.0000-20UNEF	.531	1.588		
16		.719	1.931	1.250	1.015
18	1.1250-18NEF			1.344	1.140
20	1.2500-18NEF			1.469	1.281
22	1.3750-18NEF		1.594	1.406	
24	1.5000-18NEF		1.719	1.531	
28	1.7500-18NS		2.010	1.969	1.781
32	2.0000-18NS		2.072	2.219	2.031
36	2.2500-16UN	2.469		2.655	
40	2.5000-16UN	2.430		2.7189	3.000

RHIMCO'S EXAMPLE PART NUMBER

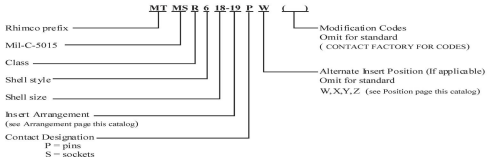

MTMS MODIFIED CONNECTORS

The MTMSM / MTMSML series connectors utilizes the same insert arrangements and electrical ratings as illustrated in the "Contacts and Arrangements" section of this catalog. Standard MS coupling and polarization is employed.

The contacts are SILVER plated solder type, fabricated from high grade copper.

The aluminum components are cadmium plated with an olive drab chromate after treatment.

Cable mounting connectors are supplied with a compression gland sealing nut for sealing on jacketed cables.



Contacts Solder Type

CONTACT PART NUMBER DATA		
SIZE	PIN CONTACT PART NUMBER	SOCKET CONTACT PART NUMBER
16 (SHORT)	MT5015SS-16P	MT5015SS-16S
16 (LONG)	MT5015SL-16P	MT5015SL-16S
12	MT5015SL-12P	MT5015SL-12S
8	MT5015SL-8P	MT5015SL-8S
4	MT5015SL-4P	MT5015SL-4S
0	MT5015SL-0P	MT5015SL-0S

Machined high grade copper alloy contacts are silver-plated for maximum corrosion resistance, (other finishes available), with a minimum millivolt drop and a maximum current carrying capacity. The size 16 socket contacts are of the closed entry design. Solder type contact are available in all 5015 insert arrangement which contain contact size 0, 4, 8, 12, and / or 16.

SOLDER WELL DATA

Contact size	0	4	8	12	16
Well Inside +.005					
Diameter -.003	.469	.332	.209	.116	.078
Well Depth +.031 -.000	.625	.625	.500	.375	.250
Solder Well Barrel Outside +.004 Diameter -.003	.547	.394	.256	.146	.103
Recommended Wire Size Per MIL-W-5086	0,1,2	4,6	8,10	12,14	16,18,20,22

ELECTRICAL DATA

The 5015 Service Data listed below illustrate the electrical ratings and physical spacing between the contacts and the shell.

TABLE I

CONTACT SIZE	CONTACT RATING		POTENTIAL DROP MILLIVOLTS MAX.
	RATED CURRENT	TEST CURRENT	
16	13	20	21
12	23	35	20
8	46	60	12
4	80	110	10
0	150	200	10

TABLE II

MS SERVICE	CONTACT ARRANGEMENT SERVICE RATING				
	RECOMMENDED OPERATING VOLTAGE* AT SEA LEVEL		EFFECTIVE CREEPAGE DISTANCE NOM	MECHANICAL SPACING NOM	
	DC	AC RMS			
INST.	250	200	1/16	—	
A	700	500	1/8	1/16	
D	1250	900	3/16	1/8	
E	1750	1250	1/4	3/16	
B	2450	1750	5/16	1/4	
C	4200	3000	1	5/16	

* The values listed in Table I represent operating values which include a generous safety factor. It may be necessary for some applications to exceed the operating voltages listed here. If this is necessary, designers will find Table II useful for determining the degree to which the recommended values of Table I can be exceeded.

ALTITUDE VOLTAGE DERATING** CHART

MS SERVICE RATING	NOMINAL DISTANCE		STANDARD SEA LEVEL CONDITIONS		PRESSURE ALTITUDE+ 50,000 FEET		PRESSURE ALTITUDE+ 70,000 FEET	
	AIRSPACE	CREEPAGE	MINIMUM FLASHOVER VOLTAGE VAC RMS	TEST VOLTAGE VAC RMS	MINIMUM FLASHOVER VOLTAGE VAC RMS	TEST VOLTAGE VAC RMS	MINIMUM FLASHOVER VOLTAGE VAC RMS	TEST VOLTAGE VAC RMS
INST	1/32	1/16	1400	1000	550	400	325	250
A	1/16	1/8	2800	2000	800	600	450	350
D	1/8	3/16	3600	2800	900	675	500	400
E	3/16	1/4	4500	3500	1000	750	550	440
B	1/4	5/16	5700	4500	1100	825	600	480
C	5/16	1	8500	7000	1300	975	700	560

+Not corrected for changes in density due to variations in temperature.

**No attempt has been made to recommend operating voltages. The designer must determine his own operating voltages by application of a safety factor to the derating chart to compensate for circuit transients, surges, etc.

CONTACTS

SOLDER

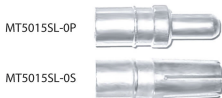
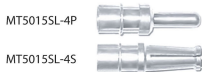

CRIMP



THERMOCOUPLE

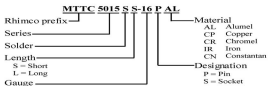



MTMSFP FLANGE PLUG

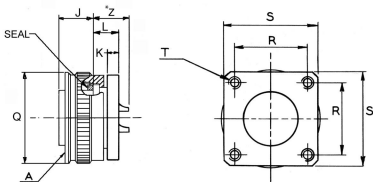

* Increase (Z) dimension by .312 for size "0" contacts only.

Shell Size	A Thread Class 2B	J +/- .005	K +/- .005	L +/- .020	Q Max	R +/- .005	S +/- .020	T Thread Class 2B	* Z +/- .045
8S	.5000 -28UNEF	.531	.125	.438	.750	.562	.781	4-40NC	.562
10S	.6250 -24NEF				.945				
10SL					.126				
12S	.7500 -20UNEF	.719	.156	.688	1.125	.812	1.062	6-32NC	.812
12		.531		.438					.562
14S	.8750 -20UNEF	.719		.688					.812
14		.531	.188	.438	1.250	1.000	1.312	10-32NF	.562
16S	1.0000 -20UNEF	.719		.688					1.250
16		.531		.688					1.000
18	1.1250 -18NEF	.719	.188	.687	1.344	1.250	1.625	10-32NF	.812
20	1.2500 -18NEF				1.469				
22	1.3750 -18NEF				1.594				
24	1.5000 -18NEF				1.719				
28	1.7500 -18NS				1.969				
32	2.000 -18NS				2.219				
36	2.2500 -16UN	.250	.781	2.469	2.219	1.812	2.500		
40	2.5000 -16UN								2.719

RHIMCO'S EXAMPLE PART NUMBER

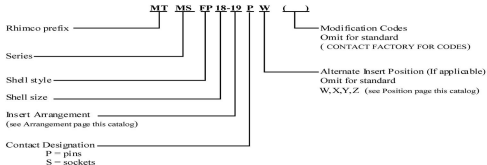

* MTMSM 0 WALL MOUNT RECEPTACLE

** This connector also available in MTMSML series, which uses a longer back shell assembly for the customer requiring more stripping distance.

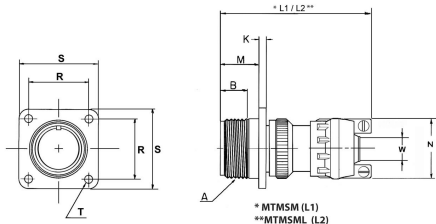

Shell Size	A Thread Class 2A	B Min Full Thd	K +.020 -.10	*L1 MAX	**L2 MAX	N Max	R +/- .005	S +/- .020	T +.004 -.002	W			
										Free	Closed		
8S	.5000-28UNEF	.391	.672	2.179	2.446	.812	.594	.875	.120	.219	.031		
10S	.6250-24NEF			2.202	2.470		.719	1.000					
10SL	.6250-24NEF			2.327	2.595		.937	.812				1.094	
12S	.7500-20UNEF	.450	2.202	2.470									
12	.7500-20UNEF	.625	.860	2.577	2.870	1.062	.906	1.188	.438	.250			
14S	.8750-UNEF	.450	.672	2.202	2.470								
14	.8750-UNEF	.625	.860	2.577	2.870								
16S	1.0000-20UNEF	.450	.672	2.202	2.470	1.188	.969	1.281	.531	.312			
16	1.0000-20UNEF			.860	2.577						2.870		
18	1.120-18NEF			.891	.891						2.604	2.897	1.312
20	1.2500-18NEF	2.717	3.260			1.562	1.156	1.500					
22	1.3750-18NEF	2.727	3.520				1.250	1.625					
24	1.5000-18NEF	.625	.953	2.789	3.832	1.750	1.375	1.750	.147	.938	.594		
28	1.7500-18NS			3.007	4.003		1.562	2.000					
32	2.0000-18NS			1.031	.953		3.035	4.281				2.250	1.750
36	2.2500-16UN	3.035	4.281			2.375	1.938	2.500	1.375	.969			
40	2.5000-16UN	3.302	4.798			2.625	2.188	2.750			1.625		1.188

RHIMCO'S EXAMPLE PART NUMBER

MT MSM 0 18-19 P W ()

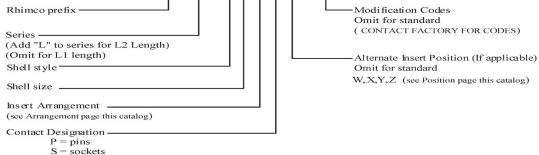

MTK STANDARD CONNECTORS

MTK STANDARD Connectors have a special Acme thread for rugged coupling. These connectors are extremely versatile, lightweight and economical. MTK Standard Connectors have made the quick disconnect concept an industry standard, saving time and money on servicing, assembly, testing and inspection.



MTK1W-6PSR 5/16



MTK6W-6SSR 5/16

CONTACT RHIMCO FOR DETAILED INFORMATION

"MTMC" MINIATURE CONNECTORS

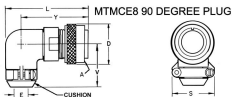

SHELL SIZE	A THREAD	D	E	L	S	V	Y
8	1/2-6	.656	.218	1.343	.687	.718	1.125
10	5/8-6	.781	.250	1.500	.812	.812	1.218
13	13/16-6	.937	.406	1.656	.968	.937	1.281

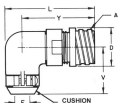

MTMC9 90 DEGREE PLUG



SHELL SIZE	A THREAD	D	E	L	S	V	Y
8	1/2-6	.531	.218	1.375	.687	.718	1.156
10	5/8-6	.656	.250	1.531	.812	.812	1.250
13	13/16-6	.875	.406	1.718	.968	.937	1.343

MTMC-59

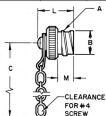

MTMC-59

SHELL SIZE	A THD ACME	B	C	L	M
8-59	1/2-6	.375	3.500	.437	.250
10-59	5/8-6	.500	3.500	.437	.250
-	-	-	-	-	-

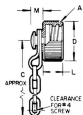

MTMC-60

MTMC-60

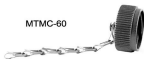

SHELL SIZE	A THD ACME	C	D	L	M
8-60	1/2-6	3.437	.640	.375	.156
10-60	5/8-6	3.437	.765	.375	.156
13-60	13/16-6	3.437	.953	.375	.156



MTMSM[®] 1 CABLE CONNECTING PLUG

** This connector also available in MTMSML series, which uses a longer back shell assembly for the customer requiring more stripping distance.

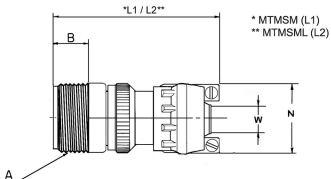

* MTMSM (L1)

** MTMSML (L2)

Shell Size	A Thread Class 2A	B Min thd	* L1 Max	** L2 Max	N Max	W	
						FREE	CLOSED
8S	.5000-28UNEF	.406	2.179	2.446	.812	.219	.031
10S	.6250-24NEF		2.202	2.470			
10SL			2.327	2.595			
12S	.7500-20UNEF	.422	2.202	2.470	.937	.312	.094
12		.656	2.577	2.870			
14S	.8750-20UNEF	.391	2.202	2.470	1.062	.438	.250
14		.625	2.577	2.870			
16S	1.0000-20UNEF	.391	2.202	2.470			
16		.625	2.577	2.870	1.188	.531	.312
18	1.125-18NEF		2.604	2.897	1.312	.625	.375
20	1.2500-18NEF		2.717	3.260	1.562	.750	.500
22	1.3750-18NEF		2.727	3.520	1.750	.938	.594
24	1.5000-18NEF		2.789	3.832			
28	1.7500-18NS		3.007	4.005	2.250	1.250	.938
32	2.0000-18NS	3.035	4.281				
36	2.2500-16UN	3.302	4.798	2.375			
40	2.5000-16UN			2.625	1.625	1.188	

RHIMCO'S EXAMPLE PART NUMBER

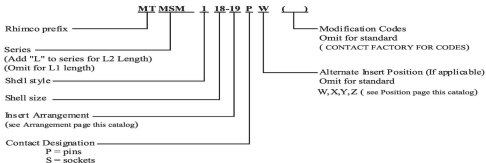

* MTMSM 6 STRAIGHT PLUG

** This connector also available in MTMSML series, which uses a longer back shell assembly for the customer requiring more stripping distance.

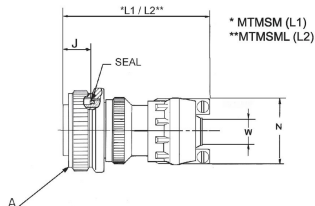

Shell Size	A Thread Class 2A	J +/- .005	*L1 Max	**L2 Max	N Max	W		
						FREE	CLOSED	
8S	.5000-28UNEF	.531	2.179	2.446	.812	.219	.031	
10S	.6250-24NEF		2.202	2.470				
10SL			2.327	2.595				
12S	.7500-20UNEF		2.202	2.470				
12		.719	2.577	2.870	.937	.312	.094	
14S	.8750-20UNEF	.531	2.202	2.470				
14		.719	2.577	2.870				
16S	1.0000-20UNEF	.531	2.202	2.470				
16			2.577	2.870	1.188	.531	.312	
18	1.125-18NEF	.719	2.604	2.897	1.312	.625	.375	
20	1.2500-18NEF		2.717	3.260	1.562	.750	.500	
22	1.3750-18NEF		2.727	3.520	1.750	.938	.594	
24	1.5000-18NEF		2.789	3.832				
28	1.7500-18NS		3.007	4.005				
32	2.0000-18NS		3.035	4.281				
36	2.2500-16UN		3.302	4.798	2.250	2.375	1.375	.969
40	2.5000-16UN				2.625	1.625	1.188	

RHIMCO'S EXAMPLE PART NUMBER

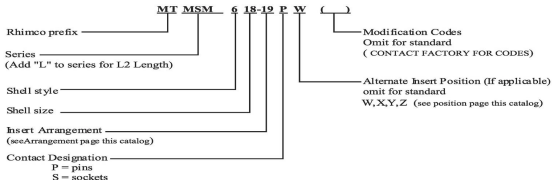

"MTMC" MINIATURE CONNECTORS

MTMCE6 STRAIGHT CORD PLUG

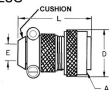

SHELL SIZE	A THD SPL ACME	D	E	L	S
8	1/2-6	.656	.218	1.156	.687
10	5/8-6	.781	.250	1.156	.812
13	13/16-6	.937	.406	1.156	.968

MTMCE1 STRAIGHT CORD PLUG

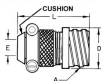

SHELL SIZE	A THD SPL ACME	D	E	L	S
8	1/2-6	.531	.218	1.187	.687
10	5/8-6	.656	.250	1.156	.812
13	13/16-6	.875	.406	1.156	.968

MTMCEFP STRAIGHT RECEPTACLE



SHELL SIZE	A THD SPL ACME	D	G	L	M	N	S	V THREAD
8	1/2-6	.687	.125	.750	.500	.656	.625	9/16-24 NEF-2A
10	5/8-6	.812	.125	.750	.500	.781	.750	11/16-24 NEF-2A
13	13/16-6	1.000	.125	.750	.500	.937	1.000	7/8-20 UNEF-2A

MTMCE4 STRAIGHT RECEPTACLE



SHELL SIZE	A THD SPL ACME	D	G	L	M	S	V THREAD
8	1/2-6	.687	.125	.656	.593	.625	9/16-24 NEF-2A
10	5/8-6	.812	.125	.656	.593	.750	11/16-24 NEF-2A
13	13/16-6	1.000	.125	.656	.593	1.000	7/8-20 UNEF-2A

"MTMC" MINIATURE CONNECTORS

RHIMCO'S EXAMPLE PART NUMBER

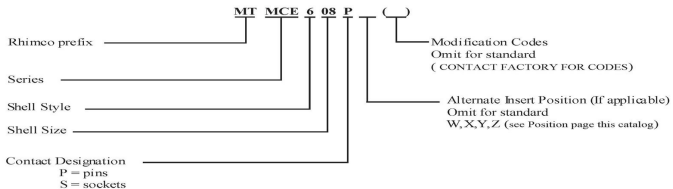

Face view of pin insert
actual size

SHELL SIZE & ARR. NO.
CONTACT SIZE
SERVICE RATING



8-3
3 #20
1



10-6
6 #20
1



13-12
12 #20
1



MTSM 8 90-DEGREE PLUG

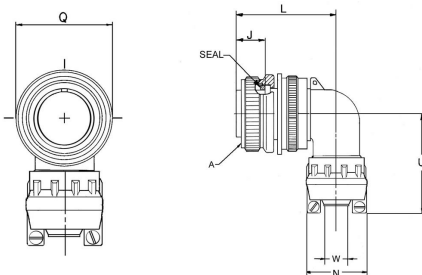

Shell Size	A Thread Class 2B	J +/- .005	L Max	N Max	Q Max	U Max	W				
							FREE	CLOSED			
8S	.5000-28UNEF	.531	1.427	.812	.844	1.550	.219	.031			
10S	.6250-24NEF		1.458		.969						
10SL			1.482								
12S	.7500-20UNEF	.719	1.487	.937	1.062	1.613	.312	.094			
12			.719						1.862		
14S	.8750-20UNEF		.531						1.651		
14		.719	1.926	1.062	1.156	1.675	.438	.250			
16S	1.000-20UNEF	.531	1.677	1.188	1.250	1.738	.531	.312			
16			2.051								
18	1.1250-18NEF		2.114						1.312	1.344	1.859
20	1.2500-18NEF	.719	2.364	1.562	1.469	2.034	.750	.500			
22	1.3750-18NEF		1.594		1.971						
24	1.5000-18NEF		2.651		1.750	1.719			2.096	.938	.594
28	1.7500-18NS	.719	2.837	2.250	1.969	2.159	1.250	.938			
32	2.0000-18NS		2.895		2.375	2.469			2.766	1.375	.969
36	2.2500-16UN		3.020		2.625	2.719			2.922	1.625	1.188
40	2.5000-16UN										

RHIMCO'S EXAMPLE PART NUMBER

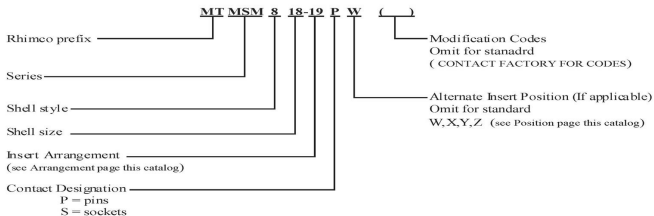

MTMOD MODIFIED CONNECTORS

This versatile series utilizes the same insert arrangements and electrical ratings as illustrated in the "Contacts and Arrangements" section of this catalog. Standard MS coupling and polarization is employed.

The contacts are insertable GOLD plated crimp type, fabricated from high grade copper.

The aluminum components are cadmium plated with an olive drab chromate after treatment.

Cable mounting connectors are supplied with a compression gland sealing nut for sealing on jacketed cables with the addition bars and screws for additional strain relief.



MTMC MINIATURE CONNECTORS

The MTMC Miniature connector was originally designed to be used in various types of audio equipment. MTMC connectors have solder contacts and aluminum shells.

MTMC Miniature connectors are available in a wide variety of environmental configurations.



MTPC__ 7 STRAIGHT PLUG

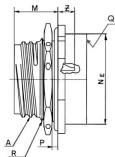
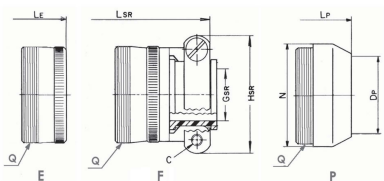

Shell Size	A thread Class 2A	C Thread	N Max	Q thread Class 2A	F $\pm .010$	L Max	LSR	H $\pm .017$ $-.016$	M $\pm .010$
6	.375 DS	---			.286		---	.625	
8	.500 DS				.331			.750	
10	.625 DS				.375			.875	
12	.750 DS	6-32			.442			1.062	.671
14	.875 DS				.486			1.188	
16	1.000 DS				.530			1.312	
18	1.125 DS				.573			1.438	
20	1.250 DS	8-32			.641			1.562	.797
22	1.375 DS				.685			1.688	

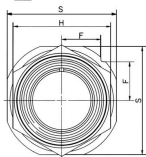

Shell Size	GSR $\pm .010$	HSR Max	LE Max	LP Max	DP Min	R Thread Class 2A	S $\pm .016$	P Min	P Max	NE Max	Z Max
6						.4375-28 UNEF	.812			.605	
8						.5625-24 NEF	.938			.730	
10						.6875-24 NEF	1.062			.855	
12						.8750-20 UNEF	1.250		.125	.980	.232
14						1.0000-20 UNEF	1.375	.062		1.105	
16						1.1250-18 NEF	1.500			1.230	
18						1.2500-18 NEF	1.625			1.355	
20						1.3750-18 NEF	1.812		.250	1.511	.262
22						1.5000-18 NEF	1.938			1.636	

RHIMCO'S EXAMPLE PART NUMBER

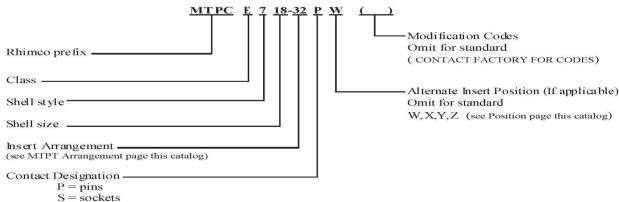



MTMOD 0 WALL MOUNTING RECEPTACLE

with Crimp gold plated contacts

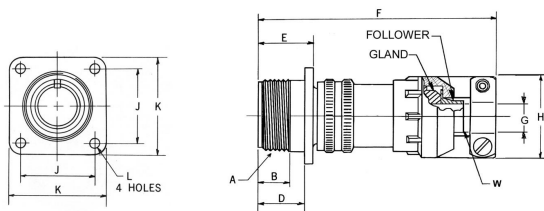

Shell Size	A Thread Class 2A	B Min Full Thd	D +.010 -.000	E +.020 -.010	F Max	G Cable Max	H Max	J +/--.005	L +.004 -.002	K	FREE	CLOSED
08	.5000-28UNEF	.391	.562	.672	3.005	.219	.812	.594	.120	.875	.219	.031
10	.6250-24NEF											
11												
12	.7500-20UNEF	.450	.750	.860	3.437	.312	.906	.812	.120	1.000	.312	.094
13		.625										
14		.450										
15	.8750-20UNEF	.625	.750	.860	3.437	.438	1.031	.906	.120	1.188	.438	.250
16		.450	.562	.672	3.005	.515	1.125	.969	.120	1.281	.531	.312
17	1.0000-20UNEF		.860	3.437								
18	1.1250-18NEF		.750	3.515	.614							
20	1.2500-18NEF	.625	.812	.953	3.780	.738	1.484	1.156	.147	1.500	.938	.938
22	1.3750-18NEF				4.030	1.250	1.625	.750		.500		
24	1.5000-18NEF				4.452	1.375	1.750			.594		
28	1.7500-18NS		.812	.953	4.874	.926	1.671	1.562	.147	2.000		
32	2.0000-18NS		.875	1.031	5.374	1.200	2.188	1.750	.173	2.250	1.250	.969
36	2.2500-16UN	5.827			1.363	2.344	1.938	2.500		1.375	1.188	
40	2.5000-16UN	6.077			1.611	2.594	2.188	2.750		1.625	1.375	

RHIMCO'S EXAMPLE PART NUMBER

MT MOD 0 18-19 P W ()

Rhimco prefix

Series

Shell style

Shell size

Insert Arrangement

(see Arrangement page this catalog)

Contact Designation

P = pins
S = sockets

Modification Codes

Omit for standard

(CONTACT FACTORY FOR CODES)

Alternate Insert Position (If applicable)

Omit for standard

W, X, Y, Z (see Position page this catalog)

MTMOD 1 MODIFIED CABLE CONNECTING RECEPTACLE

with Crimp gold plated contacts

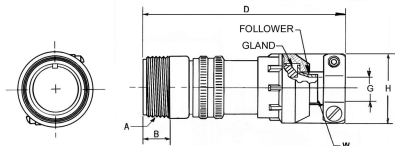

Shell Size	A Thread Class 2A	B Min Full Thd	D Max	H Max	G Cable Max	W	
						FREE	CLOSED
08	.5000-28UNEF	.391	3.005	.812	.219	.219	.031
10	.6250-24NEF						
11							
12	.7500-20UNEF	.450	3.437	.906	.312	.312	.094
13		.625					
14	.8750-20UNEF	.450	3.005	1.031	.438	.438	.250
15		.625	3.437				
16	1.0000-20UNEF	.450	3.005	1.125	.515	.531	.312
17			3.437				
18	1.1250-18NEF	.625	3.515	1.234	.614	.625	.375
20	1.2500-18NEF		3.780	1.484	.738	.750	.500
22	1.3750-18NEF		4.030	1.671	.926	.938	.594
24	1.5000-18NEF		4.452				
28	1.7500-18NS		4.874	2.188	1.200	1.250	.969
32	2.0000-18NS		5.374				
36	2.2500-16UN		5.827	2.344	1.363	1.375	1.188
40	2.5000-16UN		6.077	2.594	1.611	1.625	1.375

RHIMCO'S EXAMPLE PART NUMBER

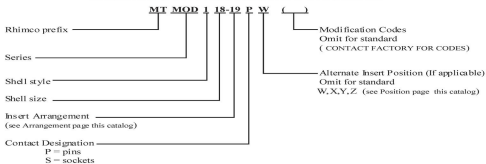



MTPC__ 6 STRAIGHT PLUG

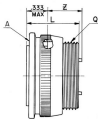
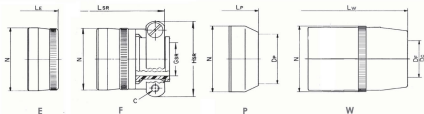

Shell Size	A thread Class 2A	C Thread	N Max	Q thread Class 2A	G Max	L Max	LSR
6	.375 DS	---	474	.3125-32 NEF	.604	---	---
8	.500 DS	6-32	600	.4375-28 UNEF	.729	.875	1.740
10	.625 DS		724	.5625-24 NEF	.854		
12	.750 DS		850	.6875-24 NEF	.979		
14	.875 DS		974	.8125-20 UNEF	1.104		
16	1.000 DS	8-32	1,100	.9375-20 UNEF	1.229	1.031	2.061
18	1.125 DS		1,224	1.0625-18 NEF	1.354		
20	1.250 DS		1,350	1.1875-18 NEF	1.478		
22	1.375 DS		1,474	1.3125-18 NEF	1.604		

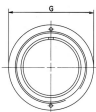

Shell Size	GSR +/-010	HSR Max	LE Max	LP Max	Dp Min	LW Max	DC Min	DF Max	Z Max
6	---	---	1.250	1.406	.192	---	---	---	627
8	.125	.812			.317	---	.168	.230	
10	.188	.875			.434	1.680	.205	.312	
12	.312	1.000			.548	1.823	.338	.442	
14	.375	1.125	1.434	1.562	.673	2.015	.416	.539	
16	.500	1.188			.798	2.231	.550	.616	
18	.625	1.438			.899	2.461	.600	.672	
20	.750	1.719			1.024	2.835	.635	.747	
22	.750	1.719	---	---	1.149	2.999	.670	.846	.783

RHIMCO'S EXAMPLE PART NUMBER

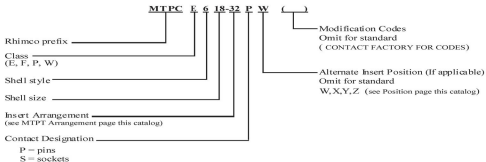

MTPC__1 WALL MOUNT RECEPTACLE

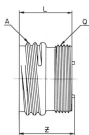
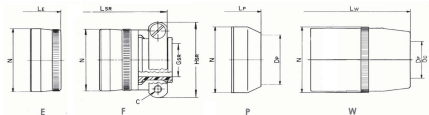

Shell Size	A thread Class 2A	C Thread	N Max	Q thread Class 2A	L Max	LSR
6	.375 DS	6-32	.474	3125-32 NEF	.875	1.740
8	.500 DS		.600	4375-28 UNEF		
10	.625 DS		.724	5626-24 NEF		
12	.750 DS		.850	6875-24 NEF		
14	.875 DS		.974	8125-20 UNEF		
16	1.000 DS		1.100	9375-20 UNEF		
18	1.125 DS	8-32	1.224	1.0625-18 NEF	1.031	2.061
20	1.250 DS		1.350	1.1875-18 NEF		
22	1.375 DS		1.474	1.3125-18 NEF		

Shell Size	GSR +/- .010	HSR Max	LE Max	LP Max	DP Min	LW Max	DC Min	DF Max	Z Max	
6	---	---	1.250	1.406	.192	---	---	---	.924	
8	.125	.812			.317	---	1.680	.168		.230
10	.188	.875			.434	---	---	.205		.312
12	.312	1.000			.548	1.823	.338	.442		---
14	.375	1.125			.673	2.015	.416	.539		---
16	.500	1.188			.798	2.231	.550	.616		---
18	.625	1.438	.899	2.461	.600	.672	---			
20	---	---	1.434	1.562	1.024	2.835	.635	.747	1.081	
22	.750	1.719			1.149	2.999	.670	.846		



RHIMCO'S EXAMPLE PART NUMBER

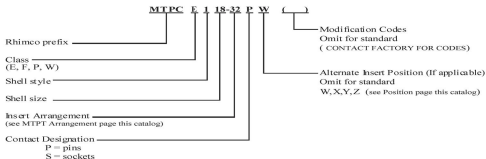



MTMOD 2 BOX MOUNTING RECEPTACLE

with Crimp gold plated contacts

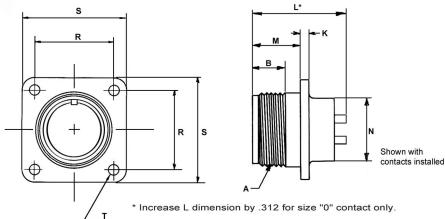

Shell Size	A Thread Class 2A	B Min Full Thd	K Max	Min	*L Max	M +.031 -.000	N +.000 -.020	R +/- .005	S +/- .031	T +.010 -.005							
8S	.5000-28UNEF	.391	.156	.062	1.191	.562	.532	.594	.875	.120							
10S	.6250-24NEF						.479	.719	1.000								
10SL							.640										
12S	.7500-20UNEF	.450	.203	.094	1.750	.750	.604	.812	1.094								
12		.625						1.191	.562								
14S	.8750-20UNEF	.450						1.191	.750		.738	.906	1.188				
14		.625	.359	.125	2.188	.875	.562	.864	.969		1.281						
16S	1.0000-20UNEF	.450											1.191				
16																	
18	1.1250-18NEF	.625	.203	.094	1.750	.750	.988	1.062	1.375		.147						
20	1.2500-18NEF						1.135	1.156	1.500								
22	1.3750-18NEF						1.260	1.250	1.625								
24	1.5000-18NEF	1.385	1.375	1.750	.812	.875	1.854	1.750	2.250								
28	1.7500-18NS	1.604	1.562	2.000													
32	2.0000-18NS	1.854	1.750	2.250													
36	2.2500-16UN	.359	.125	.125	.875	.875	2.041	1.938	2.500	.173							
40	2.5000-16UN						2.291	2.188	2.750								
44	2.7500-16UN						2.782	2.375	3.000								
48	3.0000-16UN	3.032	2.625	3.250													

RHIMCO'S EXAMPLE PART NUMBER

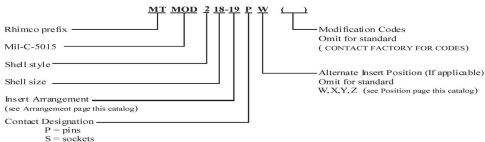

MTMOD 6
MODIFIED STRAIGHT PLUG
 with Crimp gold plated contacts

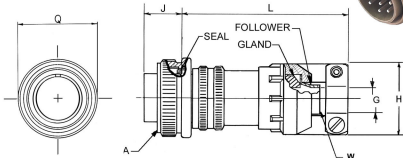

Shell Size	A Thread Class 2	G Cable Max	H Max	J +/- .005	L Max	Q Max	W	
							Free	Closed
08	.5000-28 UNEF	.219	.812	.531	2.474	.750	.219	.031
10	.6250-24 NEF		.906			.945		
11	.7500-20 UNEF	.312	.906	.719	2.718	.995	.312	.094
12			1.031					
13	.8750-20 UNEF	.438	1.125	.719	2.718	1.125	.438	.250
14								
15	1.000-20 UNEF	.515	1.125	.531	2.474	1.250	.531	.312
16								
17	1.1250-18 NEF	.614	1.234	.719	2.797	1.344	.625	.375
18								
20	1.2500-18 NEF	.738	1.484	.719	3.061	1.469	.750	.500
22	1.3750-18 NEF		1.484		3.311	1.594		
24	1.5000-18 NEF	.926	1.671	.719	3.734	1.719	.938	.594
28	1.7500-18 NS		1.671		4.156	1.969		
32	2.000-18 NS	1.200	2.188	.719	4.655	2.219	1.250	.969
36	2.2500-16 UN	1.363	2.344		5.108	2.469	1.375	1.188
40	2.500-16 UN	1.611	2.594		5.358	2.719	1.625	1.375

RHIMCO'S EXAMPLE PART NUMBER

MT MOD 6 18-19 P W ()

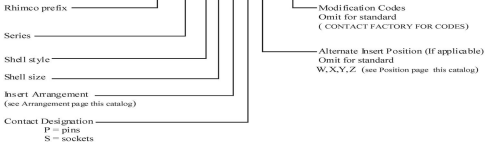



MTPC_0 WALL MOUNT RECEPTACLE

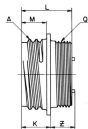
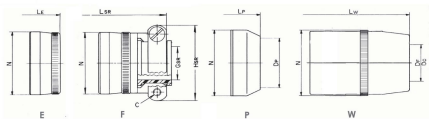

Shell Size	A thread Class 2A	C Thread	K Max	M $\begin{smallmatrix} +.000 \\ -.010 \end{smallmatrix}$	N Max	R $\begin{smallmatrix} +.005 \\ -.005 \end{smallmatrix}$	S $\begin{smallmatrix} +.005 \\ -.005 \end{smallmatrix}$	Q Thread Class 2A
6	.375 DS	---	.490	.416	.474	.469	.688	.3125032 NEF
8	500 DS	6-32			.600	.594	.812	.4375-28 UNEF
10	.625 DS				.724	.719	.938	.5625-24 NEF
12	.750 DS				.850	.812	1.031	.6875-24 NEF
14	.875 DS				.974	.906	1.125	.8125-20 UNEF
16	1.000 DS				1.100	.969	1.219	.9375-20 UNEF
18	1.125 DS		1.224	1.062	1.312	1.0625-18 UNEF		
20	1.250 DS	8-32	.584	.479	1.350	1.156	1.438	1.1875-18 UNEF
22	1.375 DS				1.474	1.250	1.562	1.3125-18 NEF

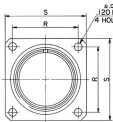

Shell Size	L Max	LSR Max	GSR $\pm .010$	HSR Max	LE Max	LP Max	DP Min	LW Max	DC Min	DF Max	Z $\begin{smallmatrix} +.040 \\ -.050 \end{smallmatrix}$
6	875	1.750	---	---	1.250	1.406	.192	---	---	---	.466
8			.125	.812			.317	1.680	.168	.230	
10			.188	.875			.434	2.015	.205	.312	
12			.312	1.000			.548	1.823	.338	.442	
14			.375	1.125			.673	2.015	.416	.539	
16			.500	1.188			.798	2.231	.550	.616	
18	1.882	2.071	.625	1.438	1.434	1.562	.899	2.461	.600	.672	
20			.899	2.461			1.024	2.835	.635	.747	
22			1.031	2.071			.750	1.719	1.149	2.999	.670

RHIMCO'S EXAMPLE PART NUMBER

MTPC E 0 18-32 P W ()

Rhimco prefix

Class
(E, F, P, W)

Shell style

Shell size

Insert Arrangement
(see MTPF Arrangement page this catalog)

Contact Designation
P = pins
S = sockets

Modification Codes
Omit for standard
(CONTACT FACTORY FOR CODES)

Alternate Insert Position (If Applicable)
Omit for standard
W, X, Y, Z (see Position page this catalog)

MTPC/E/F/P/W CONNECTORS



E

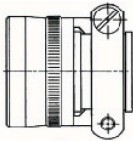

F



P



W

The MTPC series connectors are designed accommodate many time the circuits, size for size as the MS connectors (MIL-C-5015). And with several types of back hardware the Rhimco MTPC connector is your answer to your requirements for the most critical electrical circuits.

The MTPC connectors has a quick disconnect, double stub thread and offers :

- Both pin and socket copper alloy contacts.

- Closed entry probe proof socket contacts.

- Single key and keyway polarization.

- And a verity of back shell assemblies.



MTMOD 8 MODIFIED 90 DEGREE PLUG

with Crimp gold plated contacts

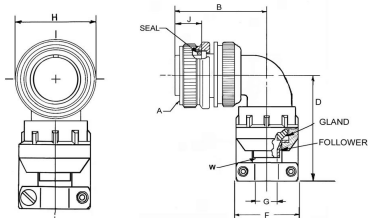

Shell Size	A Thread Class 2B	B Max	D Max	F Max	G Cable Max	H Max	J +/- .005	W			
								Free	Closed		
08	.5000-28UNEF	.927	1.729	1.427	.219	.750	.531	.219	.031		
10	.6250-24NEF	.976		1.458		.945					
11		1.143		1.482		.945					
12	.7500-20UNEF	.956	1.854	1.487	.312	.995	.719	.312	.094		
13		1.143		1.862							
14	.8750-20UNEF	1.020		1.651		.438				1.125	.531
15		1.207	1.926	.719							
16	1.0000-20UNEF	1.146	1.917	1.677	.515		1.250	.531	.531		.312
17		1.333		2.051		.719					
18	1.1250-18NEF	1.395		2.090		2.114	.614			1.344	
20	1.2500-18NEF	1.598	2.166	2.364	.738	1.469	.750	.500			
22	1.3750-18NEF	1.629	2.228	2.651	.926	1.594	.938	.938			
24	1.5000-18NEF	1.786	2.463			1.719			1.719	.938	.938
28	1.7500-18NS		2.526			1.969			1.969		
32	2.0000-18NS	2.020	3.026	2.837	1.200	2.219	1.250	.969			
36	2.2500-16UN	2.150	3.291	2.895	1.363	2.469	1.375	1.188			
40	2.5000-16UN	2.270	3.447	3.020	1.611	2.719	1.625	1.375			

RHIMCO'S EXAMPLE PART NUMBER

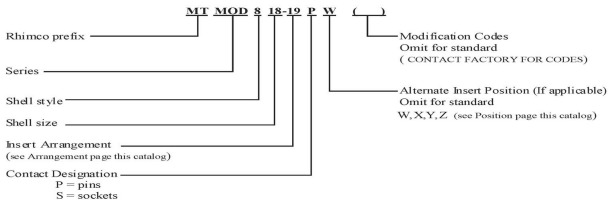



MTMOD 9
MODIFIED 45-DEGREE PLUG
 with Crimp gold plated contacts

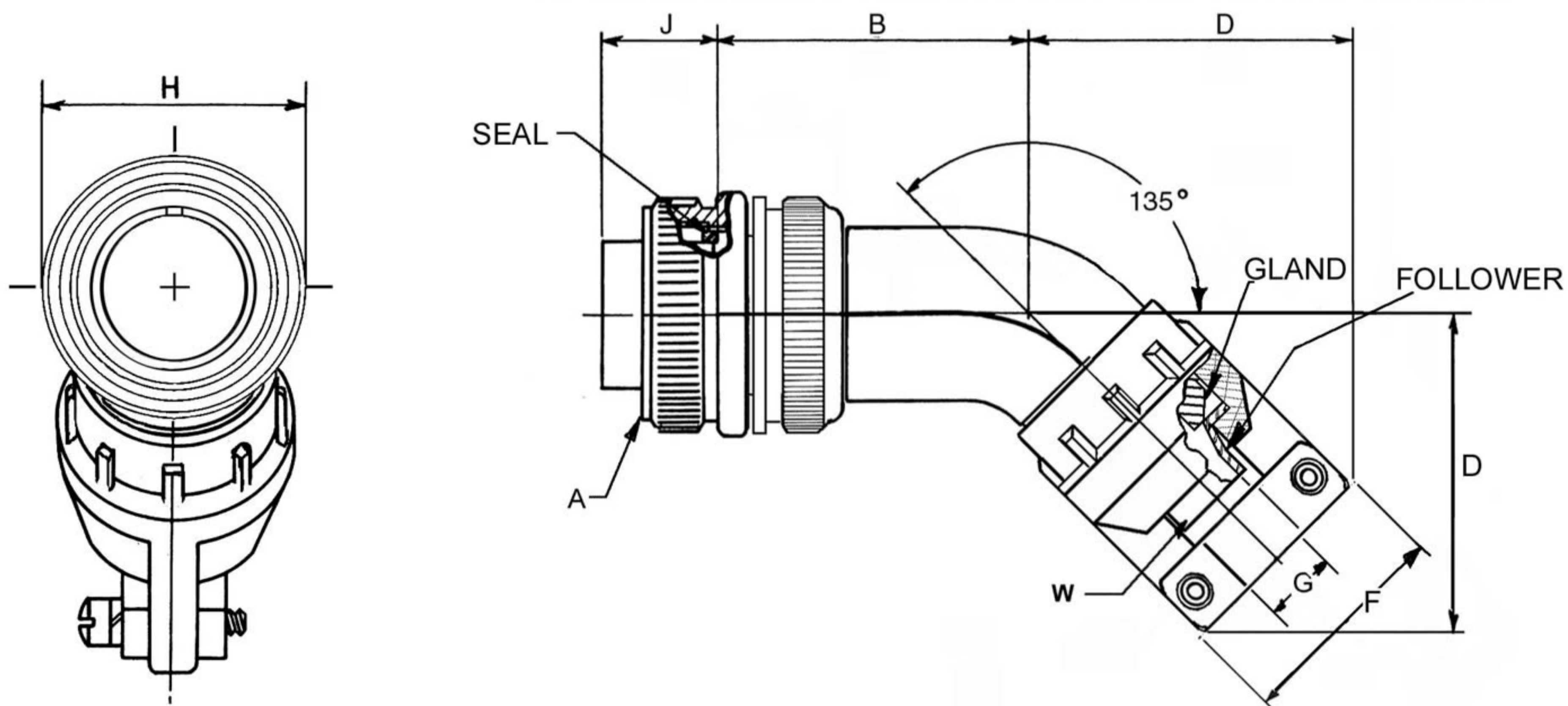

Shell Size	A Thread Class 2B	B +/-0.031	D Max	F Max	G Cable Max	H Max	J +/-0.005	W	
								Free	Closed
08	.5000-28UNEF	1.344	1.508	.812	.219	.750	.531	.219	.031
10	.6250-24NEF					.945			
11	.7500-20UNEF	1.376	1.586	.906	.312	.995	.719	.312	.094
12		1.563							
14	.8750-20UNEF	1.438	1.674	1.031	.438	1.125	.531	.438	.250
15		1.625							
16	1.0000-20UNEF	1.563	1.751	1.125	.515	1.250	.531	.531	.312
17		1.750							
18	1.1250-18NEF	1.875	1.912	1.234	.614	1.344	.719	.625	.375
20	1.2500-18NEF	2.078	2.053	1.484	.738	1.469		.750	.500
22	1.3750-18NEF		2.099			1.594			
24	1.5000-18NEF	2.266	2.331	1.671	.926	1.719	.938	.594	
28	1.7500-18NS	2.329	2.376			1.969		.938	
32	2.000-18NS	2.562	2.894	2.188	1.200	2.219	1.250	.969	
36	2.2500-16UN	2.688	3.126	2.344	1.363	2.469	1.375	1.188	
40	2.5000-16NS	2.812	3.325	2.594	1.611	2.719	1.625	1.375	

RHIMCO'S EXAMPLE PART NUMBER

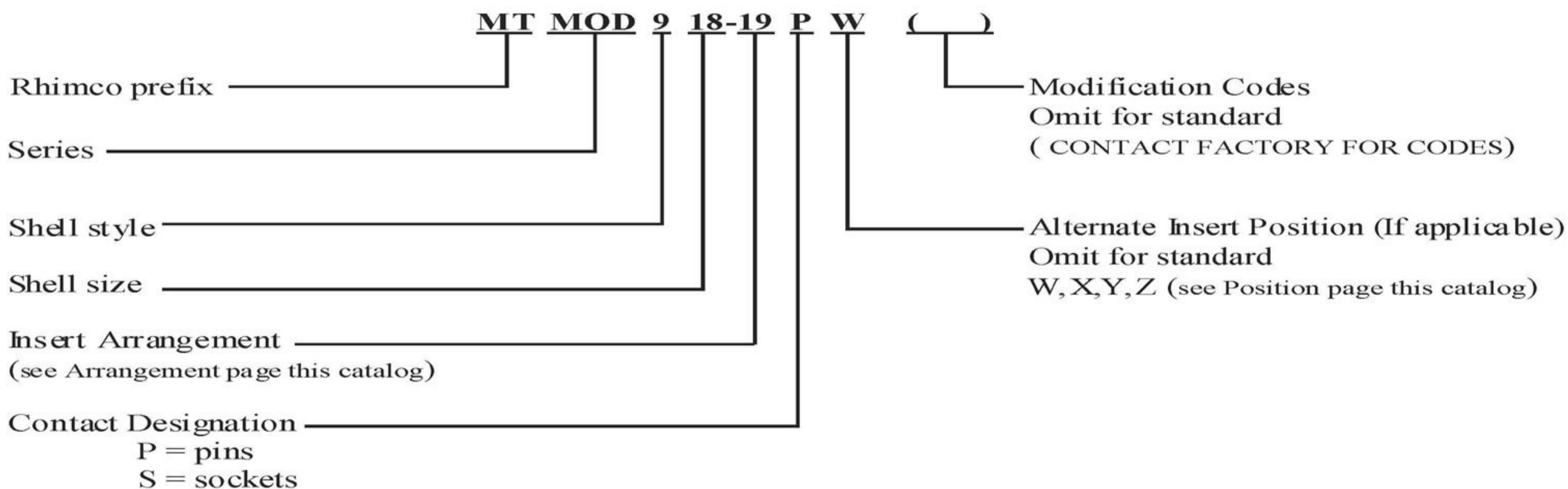



MTPCA 7 JAM NUT RECEPTACLE

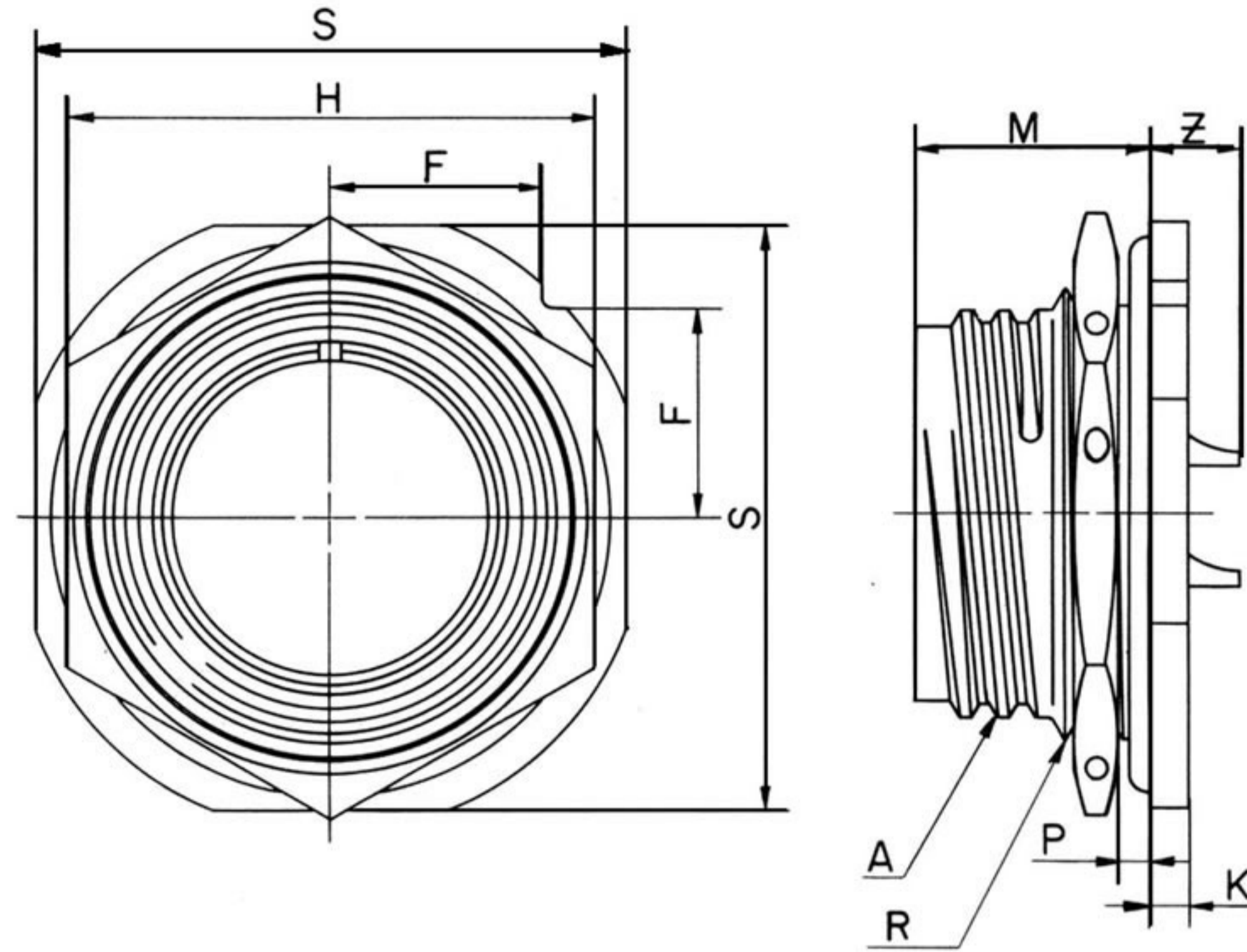

Shell Size	A thread Class 2A	F +/- .010	H +.017 -.016	K +.016 -.010	M +/- .010	P Panel Thickness		S +/- .016	Z Max	R Thread Class 2A
						Min	Max			
6	.375 DS	.286	.625	.125	.671	.062	.125	.812	.232	.4375-28 UNEF
8	.500 DS	.331	.750					.938		.5626-24 NEF
10	.625 DS	.375	.875					1.062		.6875-24 NEF
12	.750 DS	.422	1.062					1.250		.8750-20 UNEF
14	.875 DS	.486	1.188					1.375		1.0000-20 UNEF
16	1.000 DS	.530	1.312					1.500		1.1250-18 NEF
18	1.125 DS	.573	1.438					1.625		1.2500-18 NEF
20	1.250 DS	.641	1.562	.156	.797	.250	1.812	.262	1.3750-18 NEF	
22	1.375 DS	.685	1.688				1.938		1.5000-18 NEF	

RHIMCO'S EXAMPLE PART NUMBER

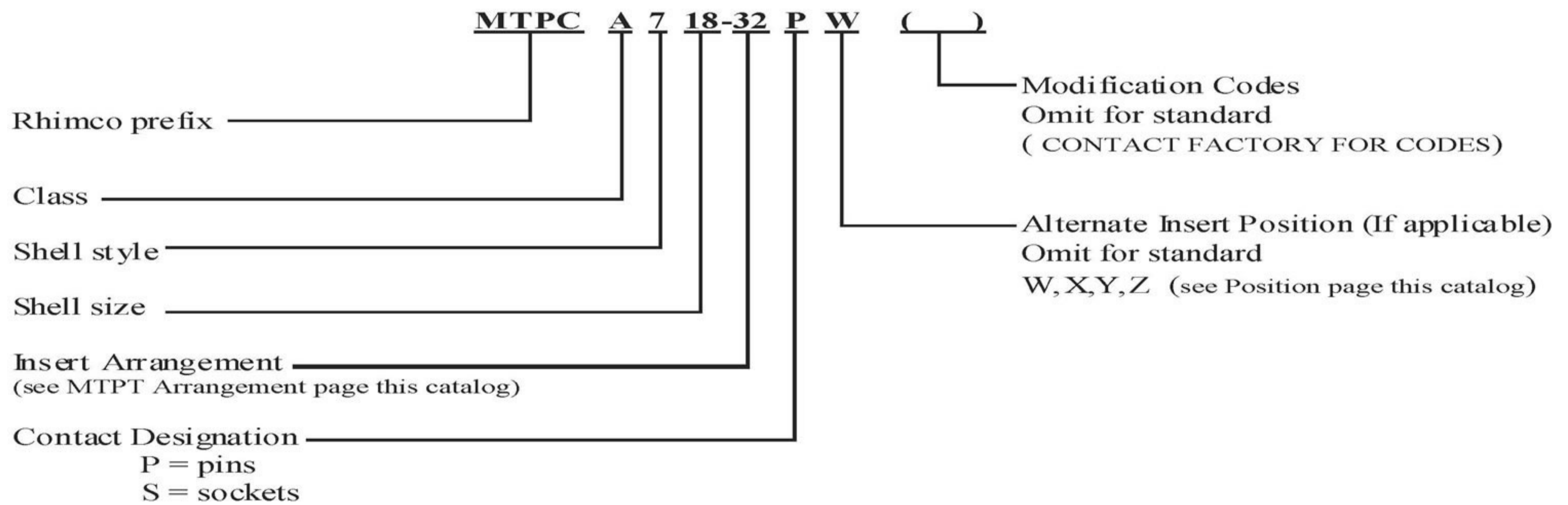

MTPCA 6 STRAIGHT PLUG

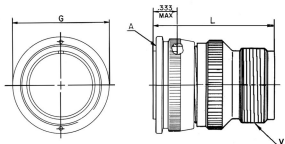

Shell Size	A thread Class 2A	G MAX	L Max	V thread Class 2A
6	.375 DS	.604	1.400	.3750-32 NEF
8	.500 DS	.729		5000-28 UNEF
10	.625 DS	.854		6250-24 NEF
12	.750 DS	.979		7500-20 UNEF
14	.875 DS	1.104		8750-20 UNEF
16	1.000 DS	1.229		1.000-20 UNEF
18	1.125 DS	1.354	1.616	1.1875-18 NEF
20	1.250 DS	1.478		1.4375-18 NEF
22	1.375 DS	1.604		

RHIMCO'S EXAMPLE PART NUMBER

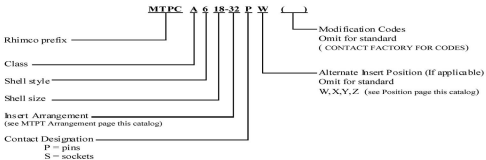



MTBFRA JAM NUT RECEPTACLE

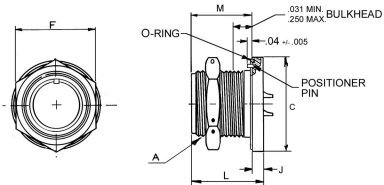

Shell Size	A Thread Class 2A	C Max	F (Hex) Max	J Max	L Max	M +/- .010
8S	.5000-28UNEF	1.072	.697			
10S	.6250-24NEF	1.197	.822	.249	1.077	.843
10SL						
12S	.7500-20UNEF	1.322	.947	.296	1.515	1.233
12						
14S	.8750-20UNEF	1.447	1.072	.249	1.077	.843
14						
16S	1.0000-20UNEF	1.572	1.260	.296	1.515	1.233
16						
18	1.1250-18NEF	1.697	1.385			
20	1.2500-18NEF	1.822	1.510			
22	1.3750-18NEF	1.947	1.635			
24	1.5000-18NEF	2.072	1.750	.296	1.515	1.233
28	1.7500-18NS	2.322	2.010			
32	2.0000-18NS	2.572	2.197			
36	2.2500-16UN	2.822	2.447			

RHIMCO'S EXAMPLE PART NUMBER

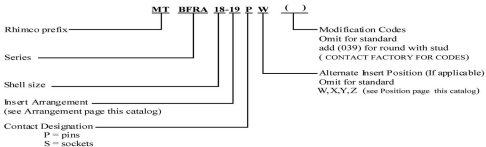

MT873 JAM NUT RECEPTACLE

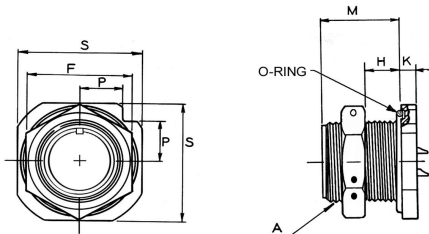

Shell Size	A Thread Class 2A	F (Hex) +/-0.016	H Panel Thickness		K +/- .005	M +/-0.010	P +/-0.10	S +/-0.10			
			Min.	Max.							
8S	.5000-28UNEF	.688	.000	.204	.156	.812	.309	.875			
10S	.6250-24NEF	.812					.329	.188	.812	.354	1.000
10SL										.142	.188
12S	.7500-20UNEF	.938					.267	.188	.812		
12				.142	.188	.812				.486	1.375
14S	.8750-20UNEF	1.062					.267	.188	.812	.575	1.625
14				.235	.188	1.156				.619	1.750
16S	1.0000-20UNEF	1.250					.298	.188	1.219	.663	1.875
16				.219	.188	1.250				.707	2.000
18	1.1250-18NEF	1.312					.298	.188	1.250	.795	2.250
20	1.2500-18NEF	1.500		.298	.188	1.250				.884	2.500
22	1.3750-18NEF	1.562					.298	.188	1.250	.972	2.750
24	1.5000-18NEF	1.750									
28	1.7500-18NS	2.000									
32	2.0000-18NS	2.188									
36	2.2500-16UN	2.438									

RHIMCO'S EXAMPLE PART NUMBER

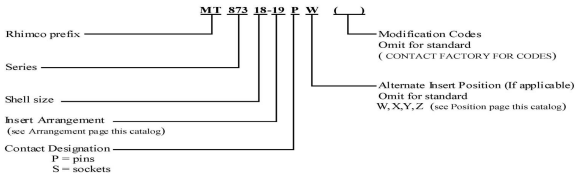



MTPCA 2 BOX MOUNT RECEPTACLE

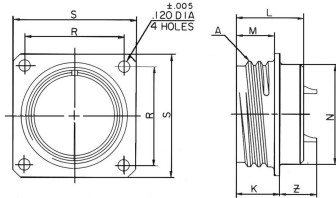

Shell Size	A thread Class 2A	K Max	L Max	M $+0.000$ -0.010	N Max	R $\pm.005$	S $\pm.005$	Z $+0.040$ -0.050
6	.375 DS	.469	.801	.406	.323	.469	.688	.466
8	.500 DS				.449	.594	.812	
10	.625 DS				.573	.719	.938	
12	.750 DS				.699	.812	1.031	
14	.875 DS				.823	.906	1.125	
16	1.000 DS				.949	.969	1.219	
18	1.125 DS				1.073	1.062	1.312	
20	1.250 DS				1.199	1.156	1.438	
22	1.375 DS	.562	.988	.469	1.323	1.250	1.562	.527

RHIMCO'S EXAMPLE PART NUMBER

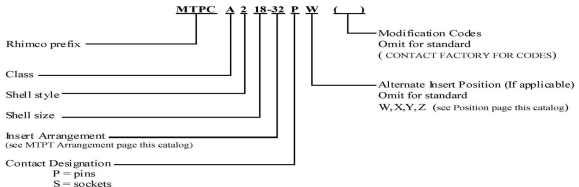

MTPCA 1 CABLE CONNECTING PLUG

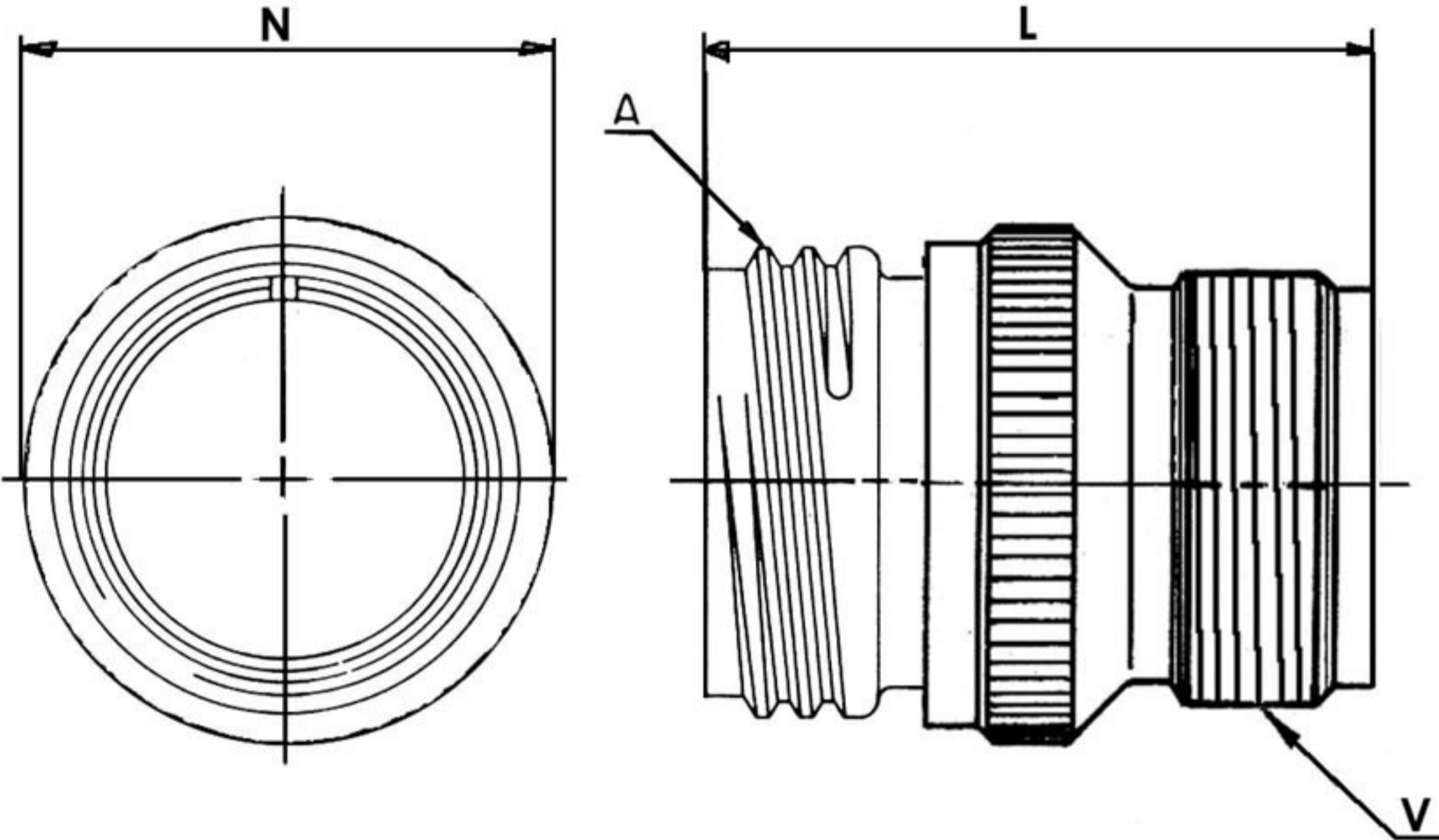

Shell Size	A thread Class 2A	L Max	V thread Class 2A	N Max
6	.375 DS	1.400	.3750-32 NEF	.462
8	.500 DS		.5000-28 UNEF	.590
10	.625 DS		.6250-24 NEF	.717
12	.750 DS		.7500-20 UNEF	.834
14	.875 DS		.8750-20 UNEF	.970
16	1.000 DS		1.000-20 UNEF	1.088
18	1.125 DS	1.6161	1.1875-18 NEF	1.216
20	1.250 DS		1.4375-18 NEF	1.332
22	1.375 DS			1.460

RHIMCO'S EXAMPLE PART NUMBER

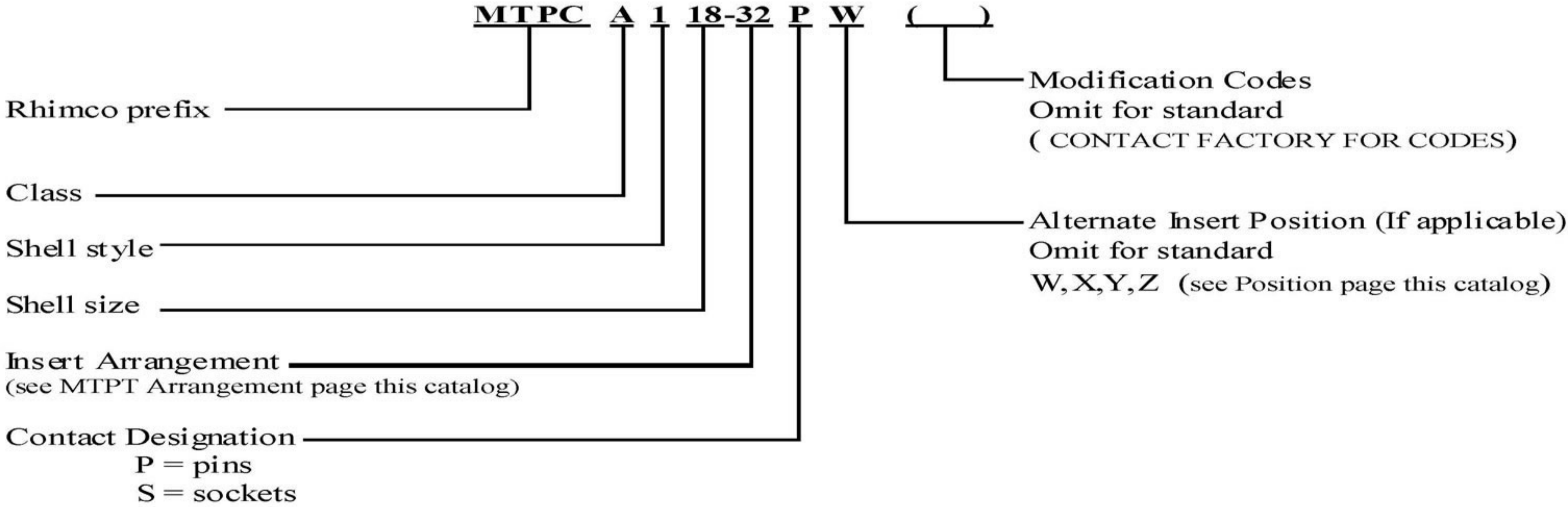



MT874 JAM NUT RECEPTACLE

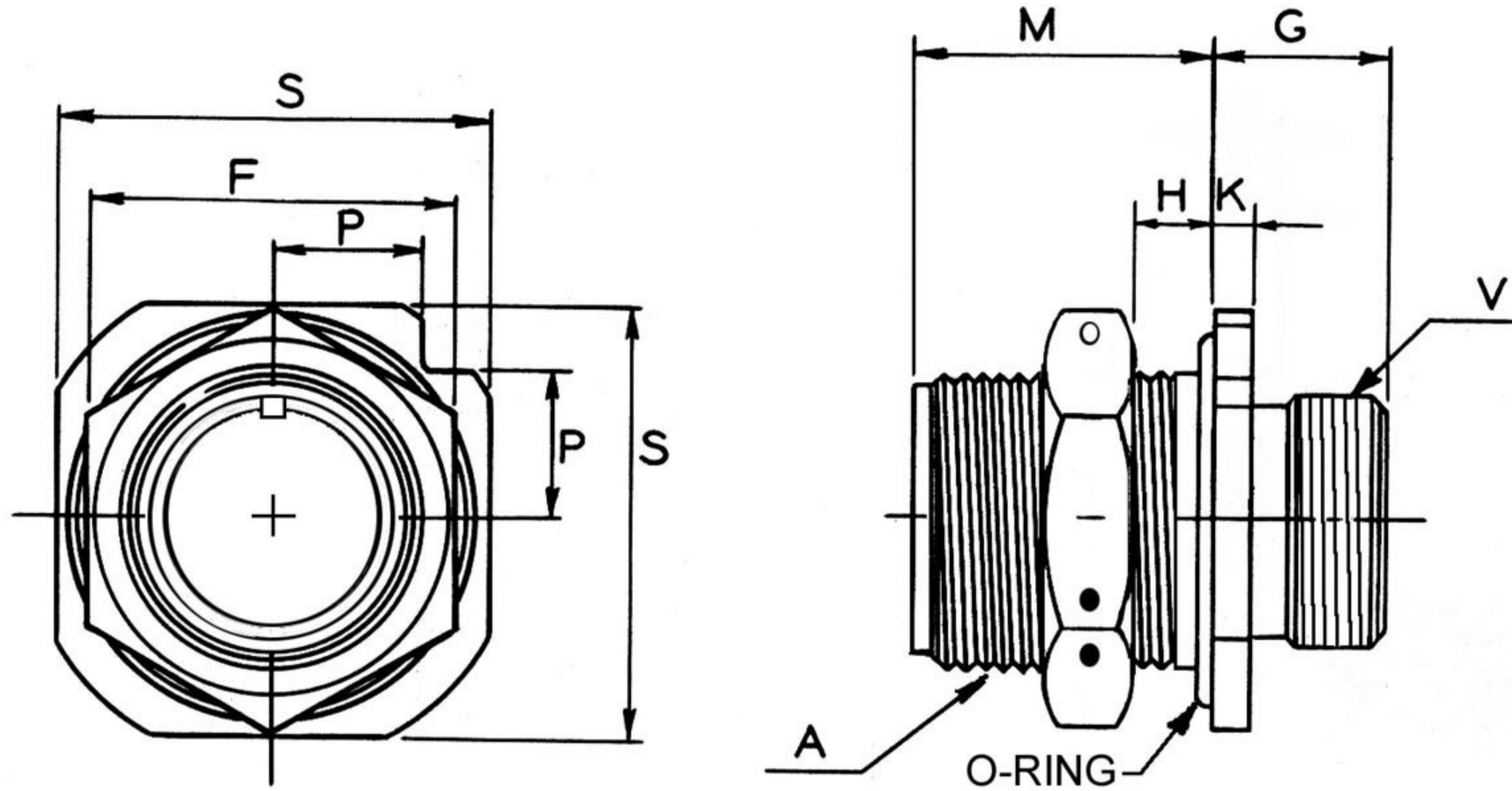

Shell Size	A Thread Class 2A	F (HEX) +/- .016	G +/- .015	H Panel Thickness		K +/- .005	M +/- .010	P +/- .010	S +/- .010	V Thread Class 2A	
				Min	Max						
10S	.6250-24NEF	.812	.525	.000	.197	.125	.806	.354	1.000	.5000-28UNEF	
10SL										.397	1.124
12S	.7500-20UNEF	.938	.713		.199		.869	.442	1.250	.7500-20UNFE	
12											1.055
14S	.8750-20UNEF	1.062	.713		.134		.869	.486	1.376	.8750-20UNEF	
14											1.055
16S	1.0000-20UNEF	1.250	.525		.199		.869	.575	1.625	1.0000-20UNEF	
16											.713
18	1.1250-18NEF	1.312	.729		.134		.156	1.055	.619	1.750	1.2500-18NEF
20	1.2500-18NEF	1.500									1.2500-18NEF
22	1.3750-18NEF	1.562	.745	.167	.172	1.088	.707	2.000	1.3750-18NEF		
24	1.5000-18NEF	1.750							1.6250-18NEF		
28	1.7500-18NS	2.000	.761	.135	.188	1.056	.884	2.500	1.8750-16NEF		
32	2.0000-18NS	2.188							2.0625-16N		
36	2.2500-16UN	2.438							2.3125-16N		
40	2.5000-16UN	2.812									

RHIMCO'S EXAMPLE PART NUMBER

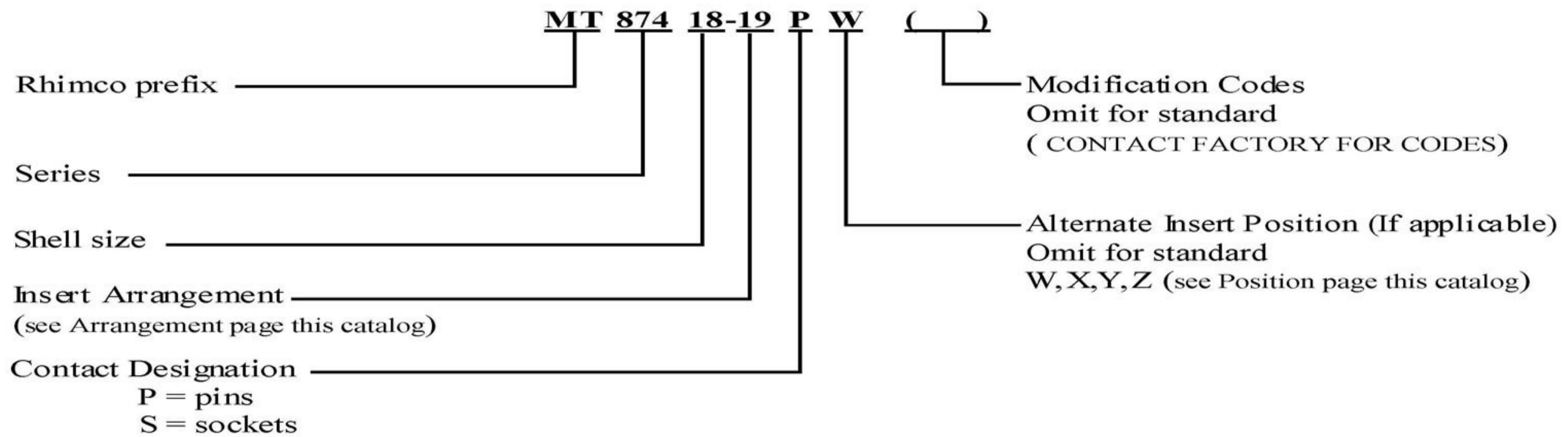

MTTBF THRU-BULKHEAD RECEPTACLE

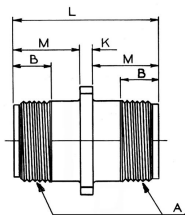
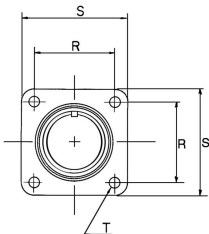

Shell Size	A Thread Class 2A	B Min Thd	K Ref	L Max	M Max	R +/- .005	S +/- .020	T +.004 -.002
8S	.5000-28UNEF	.406	.141	1.578	.711	.594	.875	.120
10S	.6250-24NEF					.719	1.000	
12S	.7500-20UNEF					.812	1.094	
12	.7500-20UNEF	.625	.155	2.140	.985	.906	1.188	
14S	.8750-20UNEF	.406	.141	1.578	.711			
14	.8750-20UNEF	.625	.155	2.140	.985			
16S	1.0000-20UNEF	.406	.141	1.578	.711			
16	1.0000-20UNEF	.625	.155	2.140	.985	.969	1.281	
18	1.1250-18NEF					1.062	1.375	
20	1.2500-18NEF					1.156	1.500	
22	1.3750-18NEF					1.250	1.625	
24	1.5000-18NEF					1.375	1.750	
28	1.7500-18NS					1.562	2.000	
32	2.000-18NS	1.750	2.250	.147				
36	2.2500-16UN	1.938	2.500					
40	2.5000-16UN	2.188	2.750		.173			

RHIMCO'S EXAMPLE PART NUMBER

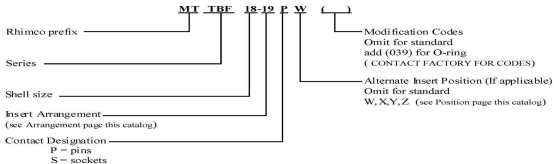



MTPCA 0 WALL MOUNT RECEPTACLE

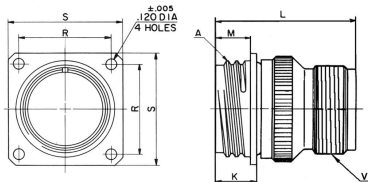

Shell Size	A thread Class 2A	K Max	L Max	M $\begin{matrix} +.000 \\ -.010 \end{matrix}$	V thread Class 2A	R $\begin{matrix} +/-.005 \end{matrix}$	S $\begin{matrix} +/-.005 \end{matrix}$
6	.375 DS	.490	1.400	.416	.3750-32 NEF	.469	.688
8	.500 DS				.5000-28 UNEF	.594	.812
10	.625 DS				.6250-24 NEF	.719	.938
12	.750 DS				.7500-20 UNEF	.812	1.031
14	.875 DS				.8750-20 UNEF	.906	1.125
16	1.000 DS				1.000-20 UNEF	.969	1.219
18	1.125 DS				1.1875-18 NEF	1.062	1.312
20	1.250 DS				1.156	1.438	
22	1.375 DS	.584	1.616	.479	1.4375-18 NEF	1.250	1.562

RHIMCO'S EXAMPLE PART NUMBER

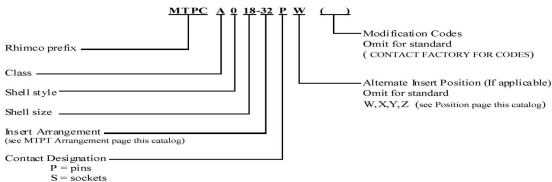

MTPC CONTACT ARRANGEMENTS

INSERT ARRANGEMENT	8-2	8-3	8-4	8-33	8-98	10-6	10-98	12-3	12-8	12-10
NUMBER OF CONTACTS	2	3	4	3	3	6	6	3	8	10
CONTACT SIZE	20	20	20	20	20	20	20	16	20	20

INSERT ARRANGEMENT	14-5	14-12	14-15	14-18	14-19	16-8	16-23	16-26	16-95
NUMBER OF CONTACTS	5	8 4	14 1	20	20	8	1 22	26	6 2
CONTACT SIZE	16	20 16	20 16	18	20	16	16 20	20	20 8 coax

INSERT ARRANGEMENT	16-99	18-11	18-30	18-32	18-85	18-88	20-16
NUMBER OF CONTACTS	2 21	11	29 1	32	5 8	4 4	16
CONTACT SIZE	16 20	16	20 16	20	20 12	20 8 coax	16

INSERT ARRANGEMENT	20-24	20-27	20-39	20-41	22-19	22-21
NUMBER OF CONTACTS	24	27	37 2	41	19	21
CONTACT SIZE	20	20	20 16	20	12	16

INSERT ARRANGEMENT	22-32	22-34	22-41	22-55	24-19
NUMBER OF CONTACTS	32	34	14 27	55	19
CONTACT SIZE	20	20	16 20	20	12

INSERT ARRANGEMENT	24-27	24-31	24-61
NUMBER OF CONTACTS	11 16	31	61
CONTACT SIZE	20 12	16	20



MTTBF (039) THRU-BULKHEAD RECEPTACLE

PANNEL SEALING

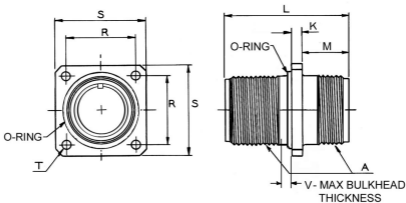

Shell Size	A Thread Class 2A	K Max	L Max	M Min	R +/- .005	S +/- .031	T +.010 -.005	V Max						
8S	.5000-28UNEF	.170	1.472	.562	.594	.906	.120	.325						
10S	.6250-24NEF				2.020	.750			.719	1.031				
10SL									.812	1.125				
12S	.7500-20UNEF		2.020	.750	.906	1.218			.173	.445				
14S	.8750-20UNEF									2.020	.750	.968	1.312	.325
14														1.000-20UNEF
16S	1.1250-18NEF									2.020	.750	1.062	1.406	
16			1.2500-18NEF	.750	1.156	1.531			1.250					1.656
18	1.3750-18NEF									.812	1.375	1.781	.147	
20			1.5000-18NEF	1.562	2.031	1.750			2.281					
22	1.7500-18NEF	1.938					2.531	1.938		2.531	.320			
24			2.000-18NS	2.188	2.781	2.188			2.781					
28	2.2500-16UN	.173					.383	.320		.383				
32			2.5000-16UN	.173	.383	.320			.383					
36	2.5000-16UN	.173					.383	.320		.383				
40			2.5000-16UN	.173	.383	.320			.383					

RHIMCO'S EXAMPLE PART NUMBER

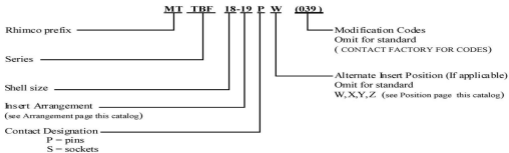

ACCESSORIES MODIFIED SERIES



MT3057 A STRAIN RELIEF

SHELL SIZE	ORDER NUMBER
8	MT3057A-8EB
10	MT3057A-10EB
11	MT3057A-11EB
12	MT3057A-12EB
13	MT3057A-13EB
14	MT3057A-14EB
15	MT3057A-15EB
16	MT3057A-16EB
17	MT3057A-17EB
18	MT3057A-18EB
20	MT3057A-20EB
22	MT3057A-22EB
24	MT3057A-24EB
28	MT3057A-28EB
32	MT3057A-32EB
36	MT3057A-36EB
40	MT3057A-40EB



MT3057 B STRAIN RELIEF

SHELL SIZE	ORDER NUMBER
8	MT3057B-8EB
10	MT3057B-10EB
11	MT3057B-11EB
12	MT3057B-12EB
13	MT3057B-13EB
14	MT3057B-14EB
15	MT3057B-15EB
16	MT3057B-16EB
17	MT3057B-17EB
18	MT3057B-18EB
20	MT3057B-20EB
22	MT3057B-22EB
24	MT3057B-24EB
28	MT3057B-28EB
32	MT3057B-32EB
36	MT3057B-36EB
40	MT3057B-40EB



MT3057 C STRAIN RELIEF

SHELL SIZE	ORDER NUMBER
8	MT3057C-8EB
10	MT3057C-10EB
11	MT3057C-11EB
12	MT3057C-12EB
13	MT3057C-13EB
14	MT3057C-14EB
15	MT3057C-15EB
16	MT3057C-16EB
17	MT3057C-17EB
18	MT3057C-18EB
20	MT3057C-20EB
22	MT3057C-22EB
24	MT3057C-24EB
28	MT3057C-28EB
32	MT3057C-32EB
36	MT3057C-36EB
40	MT3057C-40EB



TYPE 109



TYPE 290

MTMSM MODIFIED ADAPTER

SHELL SIZE	ORDER NUMBER	ORDER NUMBER
8	MTMSM109-8EB	MTMOD290-8EB
10	MTMSM109-10EB	MTMOD290-10EB
11	MTMSM109-11EB	MTMOD290-11EB
12	MTMSM109-12EB	MTMOD290-12EB
13	MTMSM109-13EB	MTMOD290-13EB
14	MTMSM109-14EB	MTMOD290-14EB
15	MTMSM109-15EB	MTMOD290-15EB
16	MTMSM109-16EB	MTMOD290-16EB
17	MTMSM109-17EB	MTMOD290-17EB
18	MTMSM109-18EB	MTMOD290-18EB
20	MTMSM109-20EB	MTMOD290-20EB
22	MTMSM109-22EB	MTMOD290-22EB
24	MTMSM109-24EB	MTMOD290-24EB
28	MTMSM109-28EB	MTMOD290-28EB
32	MTMSM109-32EB	MTMOD290-32EB
36	MTMSM109-36EB	MTMOD290-36EB
40	MTMSM109-40EB	MTMOD290-40EB



90 DEGREE ELBOW

SHELL SIZE	ORDER NUMBER
8	MTMSA94-8
10	MTMSA94-10
11	MTMSA94-11
12	MTMSA94-12
13	MTMSA94-13
14	MTMSA94-14
15	MTMSA94-15
16	MTMSA94-16
17	MTMSA94-17
18	MTMSA94-18
20	MTMSA94-20
22	MTMSA94-22
24	MTMSA94-24
28	MTMSA94-28
32	MTMSA94-32
36	MTMSA94-36
40	MTMSA94-40



45 DEGREE ELBOW

SHELL SIZE	ORDER NUMBER
8	MTMOD196-8
10	MTMOD196-10
11	MTMOD196-11
12	MTMOD196-12
13	MTMOD196-13
14	MTMOD196-14
15	MTMOD196-15
16	MTMOD196-16
17	MTMOD196-17
18	MTMOD196-18
20	MTMOD196-20
22	MTMOD196-22
24	MTMOD196-24
28	MTMOD196-28
32	MTMOD196-32
36	MTMOD196-36
40	MTMOD196-40

MTPC CONNECTORS

The MTPC series connectors are designed accommodate many time the circuits, size for size as the MS connectors (MIL-C-5015). The Rhimco MTPC connector is your answer to your requirements for the most critical electrical circuits.

The MTPC connectors has a quick disconnect, double stub thread and offers :

- Both pin and socket copper alloy contacts.

- Closed entry probe proof socket contacts.

- Single key and keyway polarization.

